

Spanner Wrenches & Sets

– Adjustable



Adjustable Hook Spanner

Capacity Range	Thickness of Handle	Thickness of Hook	Depth of Hook	Overall Length	Weight Each (lb)	Part No.	Std. Pkg. Qty.
	A	B	C	D		Industrial Black	
3/4 to 2	1/4	3/8	1/8	6-1/2	.23	471	6
1-1/4 to 3	9/32	1/2	5/32	8-1/16	.43	472	6
2 to 4-3/4	11/32	17/32	7/32	11-3/16	1.03	474	6
4-1/2 to 6-1/4	11/32	17/32	1/4	12	1.07	474A	6
6-1/8 to 8-3/4	11/32	17/32	5/16	13-5/16	1.40	474B	6

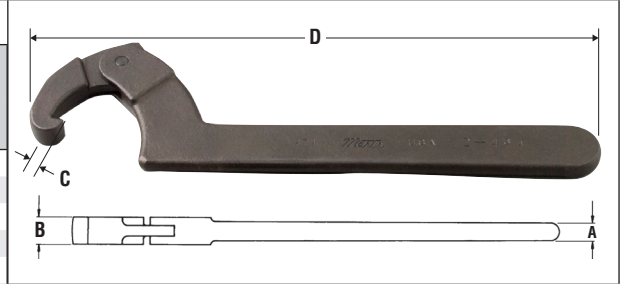

Adjustable Pin Spanner

Capacity Range	Thickness		Pin Size		Overall Length	Weight Each (lb)	Part No.	Std. Pkg. Qty.
	Handle	Hook	Diameter	Length				
	A	B	C	D				
3/4 to 2	1/4	3/8	1/8	1/8	6-1/2	.23	0471	6
3/4 to 2	1/4	3/8	3/16	5/32	6-1/2	.23	0471A	6
1-1/4 to 3	9/32	1/2	3/16	3/16	8-1/16	.42	0472	6
1-1/4 to 3	9/32	1/2	1/4	7/32	8-1/16	.42	0472A	6
2 to 4-3/4	11/32	17/32	1/4	1/4	11-3/16	.99	0474	6
4-1/2 to 6-1/4	11/32	17/32	3/8	1/4	12-3/16	1.08	0474A	6

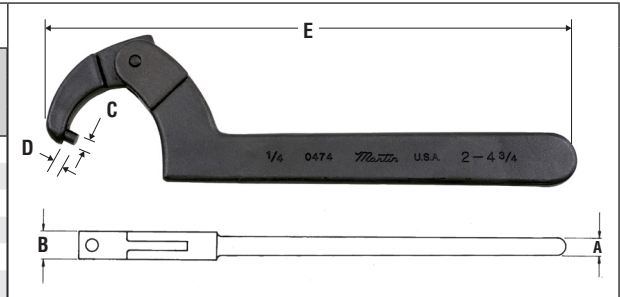

Adjustable Spanner Wrench Sets

SPW6K			SHW5K		
Image	CAPACITY RANGE	PART NO.	Image	CAPACITY RANGE	PART NO.
		3/4 to 2		0471	
	3/4 to 2	0471A		1-1/4 to 3	472
	1-1/4 to 3	0472		2 to 4-3/4	474
	1-1/4 to 3	0472A		4-1/2 to 6-1/4	474A
	2 to 4-3/4	0474		6-1/8 to 8-3/4	474B
	4-1/2 to 6-1/4	0474A		Kit Bag	C60B
	Kit Bag	C60B			

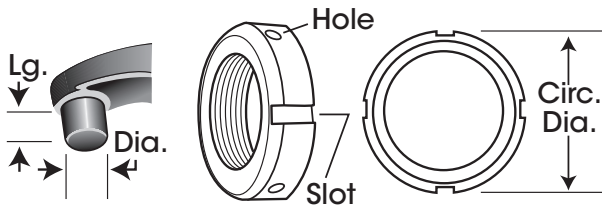

Adjustable Pin Spanner

Pins fit into the holes or slots on the side of the flange or collar.

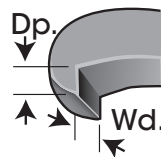

Adjustable Hook Spanner

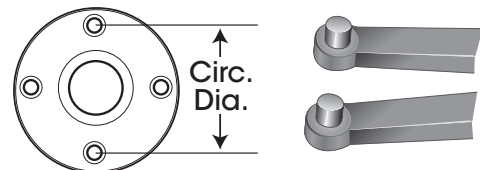

Pins fit into the holes or slots on the face of the flange or collar.

Adjustable Face Spanner

Crowfoot Wrenches

BD10		QTY.
4112	3/8 Crowfoot Wrench	1
4114	7/16 Crowfoot Wrench	1
4116	1/2 Crowfoot Wrench	1
4118	9/16 Crowfoot Wrench	1
4120	5/8 Crowfoot Wrench	1
4122	11/16 Crowfoot Wrench	1
4124	3/4 Crowfoot Wrench	1
4126	13/16 Crowfoot Wrench	1
4128	7/8 Crowfoot Wrench	1
4130	15/16 Crowfoot Wrench	1
4132	1 Crowfoot Wrench	1
4134	1-1/16 Crowfoot Wrench	1
4136	1-1/8 Crowfoot Wrench	1
4140	1-1/4 Crowfoot Wrench	1
4144	1-3/8 Crowfoot Wrench	1
4148	1-1/2 Crowfoot Wrench	1
BC20	5/8 Drive Crowfoot	1
BC22	11/16 Drive Crowfoot	1
BC24	3/4 Drive Crowfoot	1
BC26	13/16 Drive Crowfoot	1
BC28	7/8 Drive Crowfoot	1
BC30	15/16 Drive Crowfoot	1
BC32	1 Drive Crowfoot	1
BC34	1-1/16 Drive Crowfoot	1
SC36	1-1/8 Drive Crowfoot	1
SC38	1-3/16 Drive Crowfoot	1
SC40	1-1/4 Drive Crowfoot	1
SC42	1-5/16 Drive Crowfoot	1
SC44	1-3/8 Drive Crowfoot	1
SC46	1-7/16 Drive Crowfoot	1
SC50	1-9/16 Drive Crowfoot	1
SC52	1-5/8 Drive Crowfoot	1
SC54	1-11/16 Drive Crowfoot	1
SC56	1-3/4 Drive Crowfoot	1
SC58	1-13/16 Drive Crowfoot	1
SC60	1-7/8 Drive Crowfoot	1
SC62	1-15/16 Drive Crowfoot	1
SC64	2 Drive Crowfoot	1



Spanner Wrenches

BD11		QTY.
O471	3/4 to 2 Adjustable Pin Spanner	1
O471A	3/4 to 2 Adjustable Pin Spanner	1
O472	1-1/4 to 3 Adjustable Pin Spanner	1
O472A	1-1/4 to 3 Adjustable Pin Spanner	1
O474	2 to 4-3/4 Adjustable Pin Spanner	1
O474A	4-1/2 to 6-1/4 Adjustable Pin Spanner	1
471	3/4 to 2 Adjustable Hook Spanner	1
472	1-1/4 to 3 Adjustable Hook Spanner	1
474	2 to 4-3/4 Adjustable Hook Spanner	1
474A	4-1/2 to 6-1/4 Adjustable Hook Spanner	1
474B	6-1/8 to 8-3/4 Adjustable Hook Spanner	1
482	2 Adjustable Face Spanner	1
483	3 Adjustable Face Spanner	1
484	4 Adjustable Face Spanner	1

