

# 3/8 " Drive Sockets & Sets – Chrome

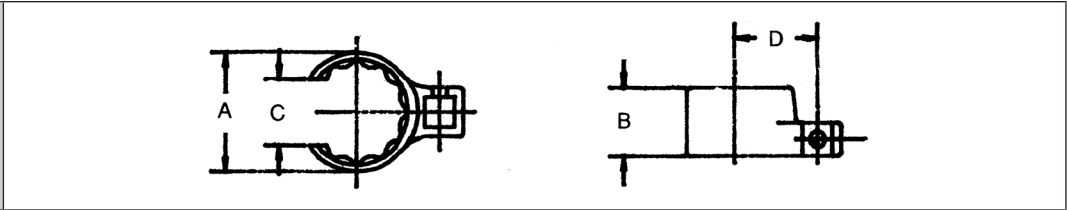

## 3/8" Drive Metric Crowfoot Wrench — Flare Nut 12 Pt.

Opening	Diameter of Head	Thickness of Head	Width of Slot	Length of Centers	Weight Each (lb)	Part Number	Std. Pkg. Qty.	Opening
	A	B	C	D		Chrome		
15 mm	24.9 mm	18.3 mm	16.5 mm	18.8 mm	0.10	BC15MM	6	15 mm
16 mm	24.9 mm	18.3 mm	16.5 mm	18.8 mm	0.10	BC16MM	6	16 mm
17 mm	27.2 mm	18.3 mm	16.5 mm	20.1 mm	0.11	BC17MM	6	17 mm
18 mm	29.7 mm	19.1 mm	16.5 mm	21.3 mm	0.12	BC18MM	6	18 mm
19 mm	29.7 mm	19.1 mm	16.5 mm	21.3 mm	0.12	BC19MM	6	19 mm
20 mm	31.8 mm	19.1 mm	16.5 mm	22.4 mm	0.13	BC20MM	6	20 mm
21 mm	31.8 mm	19.1 mm	16.5 mm	22.4 mm	0.13	BC21MM	6	21 mm
22 mm	34.0 mm	19.8 mm	16.5 mm	23.9 mm	0.14	BC22MM	6	22 mm
23 mm	36.1 mm	19.8 mm	16.5 mm	24.9 mm	0.15	BC23MM	6	23 mm
24 mm	36.1 mm	19.8 mm	16.5 mm	24.9 mm	0.15	BC24MM	6	24 mm
25 mm	38.1 mm	20.6 mm	16.5 mm	25.9 mm	0.16	BC25MM	6	25 mm
26 mm	38.1 mm	20.6 mm	16.5 mm	25.9 mm	0.16	BC26MM	6	26 mm
27 mm	39.9 mm	20.6 mm	16.5 mm	27.2 mm	0.17	BC27MM	6	27 mm



## 3/8" Drive Metric Hex Bit Sockets

Bit Size	Type	Length	Drive End	Bit End	Bit Length	Weight Each (lb)	Part Number	Replacement Hex Bit	Std. Pkg. Qty.	Bit Size
		A	B	C	D		Chrome			
4 mm	I	68 mm	17.5 mm	15.0 mm	41.0 mm	0.1	BA4MM	BA4MMB	6	4 mm
5 mm	I	68 mm	17.5 mm	15.0 mm	41.0 mm	0.1	BA5MM	BA5MMB	6	5 mm
6 mm	I	68 mm	17.5 mm	15.0 mm	41.0 mm	0.1	BA6MM	BA6MMB	6	6 mm
7 mm	I	72.5 mm	17.5 mm	15.0 mm	45.3 mm	0.1	BA7MM	BA7MMB	6	7 mm
8 mm	I	72.5 mm	17.5 mm	15.0 mm	45.3 mm	0.1	BA8MM	BA8MMB	6	8 mm
9 mm	II	72.5 mm	19 mm	19.0 mm	42.4 mm	0.15	BA9MM	BA9MMB	6	9 mm
10 mm	II	72.5 mm	19 mm	19.0 mm	42.4 mm	0.15	BA10MM	BA10MMB	6	10 mm



# 3/8 " Drive Metric Socket Sets – Chrome

## MB11K

### 3/8" Drive Metric Socket Set

10 mm 6 Pt. Std. Socket	BM610	18 mm 6 Pt. Std. Socket	BM618
12 mm 6 Pt. Std. Socket	BM612	19 mm 6 Pt. Std. Socket	BM619
13 mm 6 Pt. Std. Socket	BM613	Reversible Ratchet	B52
14 mm 6 Pt. Std. Socket	BM614	3" Extension	B103
15 mm 6 Pt. Std. Socket	BM615	Spark Plug Socket	BD620P
17 mm 6 Pt. Std. Socket	BM617	Metal Box	92



METRIC

## MB12K

### 3/8" Drive Metric 12 Point Standard Socket Set

8 mm 12 Pt. Std. Socket	BM1208	15 mm 12 Pt. Std. Socket	BM1215
9 mm 12 Pt. Std. Socket	BM1209	16 mm 12 Pt. Std. Socket	BM1216
10 mm 12 Pt. Std. Socket	BM1210	17 mm 12 Pt. Std. Socket	BM1217
11 mm 12 Pt. Std. Socket	BM1211	18 mm 12 Pt. Std. Socket	BM1218
12 mm 12 Pt. Std. Socket	BM1212	19 mm 12 Pt. Std. Socket	BM1219
13 mm 12 Pt. Std. Socket	BM1213	Twist Lock Clip Rail	213B
14 mm 12 Pt. Std. Socket	BM1214		



METRIC

## MB14K

### 3/8" Drive Metric 6 Point Standard Socket Set

6 mm 6 Pt. Std. Socket	BM606	14 mm 6 Pt. Std. Socket	BM614
7 mm 6 Pt. Std. Socket	BM607	15 mm 6 Pt. Std. Socket	BM615
8 mm 6 Pt. Std. Socket	BM608	16 mm 6 Pt. Std. Socket	BM616
9 mm 6 Pt. Std. Socket	BM609	17 mm 6 Pt. Std. Socket	BM617
10 mm 6 Pt. Std. Socket	BM610	18 mm 6 Pt. Std. Socket	BM618
11 mm 6 Pt. Std. Socket	BM611	19 mm 6 Pt. Std. Socket	BM619
12 mm 6 Pt. Std. Socket	BM612	Twist Lock Clip Rail	218B
13 mm 6 Pt. Std. Socket	BM613		



METRIC

## BA7KM

### 3/8" Drive Metric Hex Bit Socket Set

4 mm Hex Bit Socket	BA4MM	8 mm Hex Bit Socket	BA8MM
5 mm Hex Bit Socket	BA5MM	9 mm Hex Bit Socket	BA9MM
6 mm Hex Bit Socket	BA6MM	10 mm Hex Bit Socket	BA10MM
7 mm Hex Bit Socket	BA7MM	Twist Lock Clip Rail	208B



METRIC

## BC13KM

### 3/8" Drive Metric 12 Point Crowfoot Set

15 mm 12 Pt. Crowfoot	BC15MM	22 mm 12 Pt. Crowfoot	BC22MM
16 mm 12 Pt. Crowfoot	BC16MM	23 mm 12 Pt. Crowfoot	BC23MM
17 mm 12 Pt. Crowfoot	BC17MM	24 mm 12 Pt. Crowfoot	BC24MM
18 mm 12 Pt. Crowfoot	BC18MM	25 mm 12 Pt. Crowfoot	BC25MM
19 mm 12 Pt. Crowfoot	BC19MM	26 mm 12 Pt. Crowfoot	BC26MM
20 mm 12 Pt. Crowfoot	BC20MM	27 mm 12 Pt. Crowfoot	BC27MM
21 mm 12 Pt. Crowfoot	BC21MM	Twist Lock Clip Rail	208B



METRIC