

AIR COUPLERS & PLUGS

COUPLER/PLUG STYLES

- Milton® offers 11 different automotive & industrial styles
- Most styles are not interchangeable. However, couplers & plugs within the same style, from most manufacturers, will work together
- Milton®'s "Match-Up System" ensures that all couplers and plugs with the same letter code can be used together regardless of thread size
- Milton®'s 3-way couplers (page 5) simplify the process by working with A, M® & T style plugs
- Milton®'s 5 in ONE™ universal couplers (page 4) are the ultimate in versatility. They securely connect with A, M®, T, V & L style plugs
- Couplers & plugs are not D.O.T. certified

MILTON® INDUSTRIAL PLUG IDENTIFIER

<p>M-Style® Milton/Industrial Interchange</p> <p>$.211$ $\frac{1}{4}$" FLOW SIZE</p> <p>PAGE 6</p>	<p>V-Style High Flow/European Interchange</p> <p>$.185$ $\frac{1}{4}$" FLOW SIZE</p> <p>PAGE 9</p>	<p>A-Style ARO "210" Interchange</p> <p>$.325$ $\frac{1}{4}$" FLOW SIZE</p> <p>PAGE 10</p>
--------------------------------------------------------------------------------------------------------------------------------------------	--------------------------------------------------------------------------------------------------------------------------------------------	------------------------------------------------------------------------------------------------------------------------------------

NOTE: PLUG PROFILES ARE ACTUAL SIZE

<p>T-Style Tru-flate/Parker Interchange</p> <p>$.085$ $\frac{1}{4}$" FLOW SIZE</p> <p>PAGE 11</p>	<p>L-Style Lincoln Interchange</p> <p>$.792$ $\frac{1}{4}$" FLOW SIZE</p> <p>PAGE 12</p>	<p>D-Style Diamond-U Interchange</p> <p>$.170$ $\frac{1}{4}$" FLOW SIZE</p> <p>PAGE 12</p>	<p>P-Style Tru-flate/Parker Interchange</p> <p>$.128$ $\frac{3}{8}$" FLOW SIZE</p> <p>PAGE 13</p>
<p>H-Style Milton/Industrial Interchange</p> <p>$.312$ $\frac{3}{8}$" FLOW SIZE</p> <p>PAGE 14</p>	<p>AA-Style ARO "310" Interchange</p> <p>$.589$ $\frac{3}{8}$" FLOW SIZE</p> <p>PAGE 14</p>	<p>G-Style (.125) Tru-flate/Parker Interchange</p> <p>$.125$ $\frac{1}{2}$" FLOW SIZE</p> <p>PAGE 15</p>	<p>G-Style (.375) Milton/Industrial Interchange</p> <p>$.375$ $\frac{1}{2}$" FLOW SIZE</p> <p>PAGE 15</p>

WARNING: FOR USE WITH COMPRESSED SHOP AIR ONLY. NOT FOR BREATHABLE AIR USE

AIR HANDLING CAPACITY

- Basic Flow Size defines the air flow capacity
- Please do not confuse Basic Flow Size with Thread Size
- Thread Size is not directly related to air flow capacity in any way

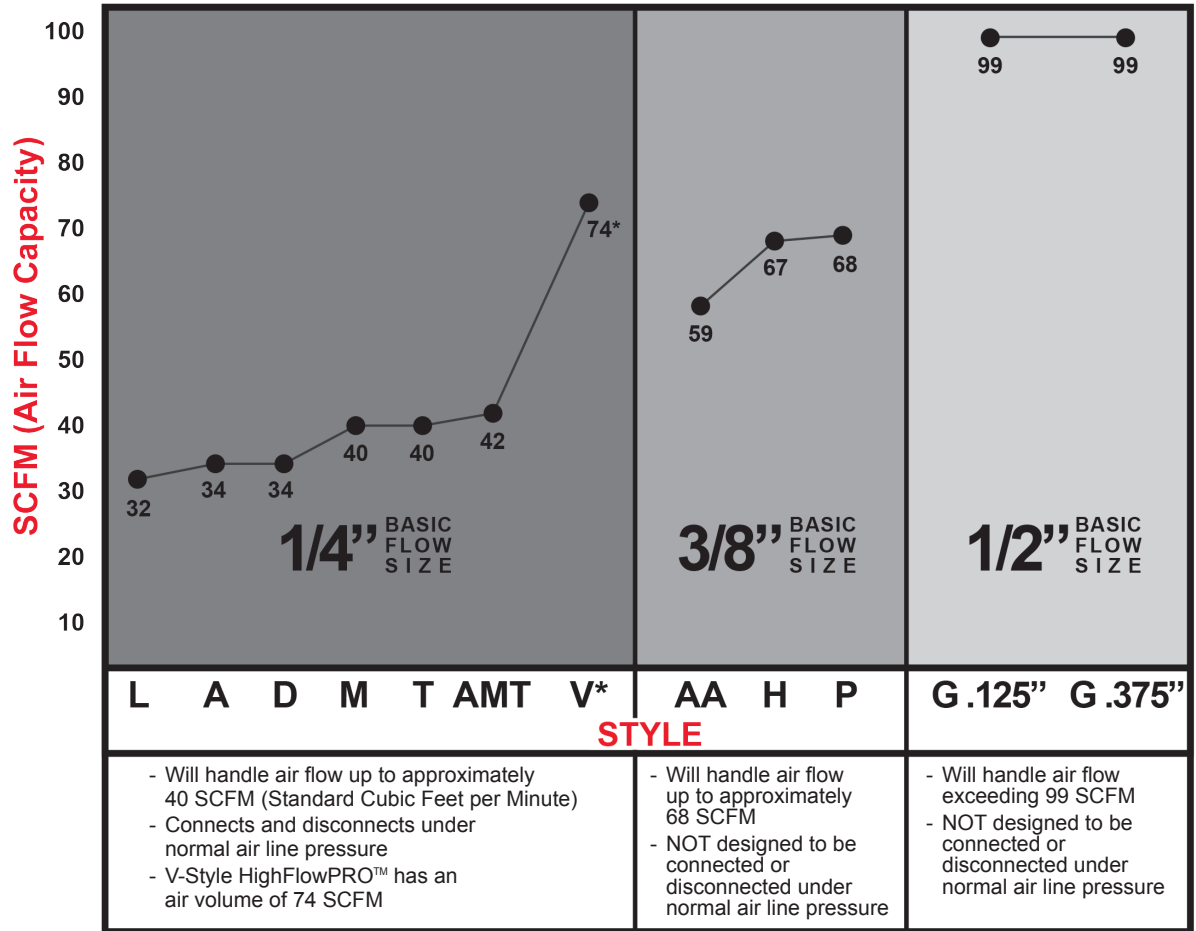

- Will handle air flow up to approximately 40 SCFM (Standard Cubic Feet per Minute)
- Connects and disconnects under normal air line pressure
- V-Style HighFlowPRO™ has an air volume of 74 SCFM

- Will handle air flow up to approximately 68 SCFM
- NOT designed to be connected or disconnected under normal air line pressure

- Will handle air flow exceeding 99 SCFM
- NOT designed to be connected or disconnected under normal air line pressure

*Low Pressure, High Volume

DEFINITION OF TERMS

DRAG GUARD

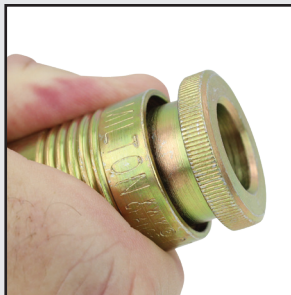

Protects couplers from accidental disconnection

PUSH-TYPE



Eliminates need to retract coupler sleeve to connect. Convenient and time saving option

PUSH-ON & LOCK

Push cut hose onto hose barb. Locks hose in place. Only for use with Push-on & Lock hose on page 24

RE-CAP

Recap plugs screw directly onto tire valves to allow for direct coupler connection and faster pressurization

COUPLERS
PLUGS
CAM/GROOVE

HOSE
HOSE REELS
FITTINGS

BLO-GUNS

FRLS

PUSH-TO-CONNECT

INFLATOR GAGES

PRESSURE &
SERVICE GAGES

GREASE GUNS

MERCHANDISERS

H-STYLE INDUSTRIAL INTERCHANGE

- 3/8" basic flow size
- 6 ball bearing connection
- H-Style couplers are steel, plated to resist rust
- H-Style plugs are case hardened steel, plated to resist rust
- Also known as "3/8" flow M-Style®"
- Maximum inlet pressure: 300 PSI
- Maximum temperature: 250°F
- Air flow: 67 SCFM
- Seals: Buna-N

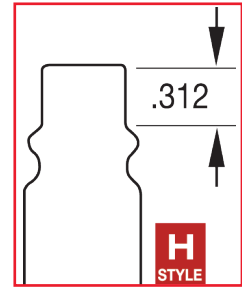

H-Style Couplers

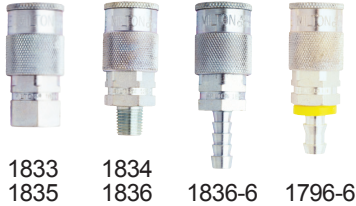

Boxed Part No.	Bulk Part No.	Retail Part No.	Per Card	NPT (in)	Product Specs Connection	Body
1833	1833BK	s-1833	1	1/4"	Female	Plated Steel
1834	1834BK	s-1834	1		Male	
1835	1835BK	s-1835	1	3/8"	Female	
1836	1836BK	s-1836	1		Male	
1836-6					3/8" ID Hose Barb	
1796-6	1796-6BK				3/8" ID Push-on & Lock Hose Barb	

SEE PG. 24 FOR PUSH-ON & LOCK HOSE

H-Style Plugs

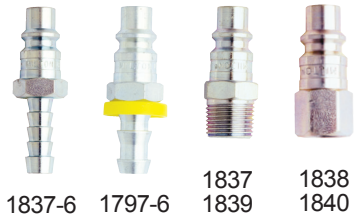

Boxed Part No.	Bulk Part No.	Retail Part No.	Per Card	NPT (in)	Product Specs Connection	Material
1839	1839BK	s-1839	2	1/4"	Male	Case Hardened Plated Steel
1840	1840BK	s-1840	2		Female	
1837	1837BK	s-1837	2	3/8"	Male	
1838	1838BK	s-1838	2		Female	
1837-6	1837-6BK				3/8" ID Hose Barb	
1797-6					3/8" ID Push-on & Lock Hose Barb	

H-Style 3/8" Coupler/Plug Kits



Kit Part No.	Kit includes (qty):				
	#1835	#1836	#1837	#1838	#652-4
s-223	1	1	1	1	1
s-1835-4	4				



AA-STYLE ARO "310"

AA-STYLE ARO "310" INTERCHANGE

- 3/8" basic flow size
- AA-Style couplers are push type
- AA-Style coupler bodies are heavy duty steel
- AA-Style plugs are case hardened steel, plated to resist rust
- Maximum inlet pressure: 300 PSI
- Maximum temperature: 250°F
- Air flow: 59 SCFM
- Seals: Buna-N

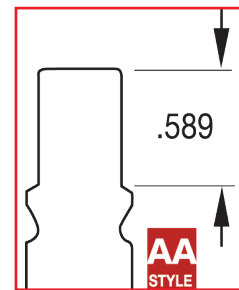

AA-Style Couplers



Boxed Part No.	Product Specs			
	NPT (in)	Connection	Body	Feature
1875	3/8"	Female	Heavy Duty Steel	Push Type

AA-Style Plugs



Boxed Part No.	NPT (in)	Product Specs	
		Connection	Body
1877	3/8"	Male	Case Hardened
1878		Female	Plated Steel

WARNING: FOR USE WITH COMPRESSED SHOP AIR ONLY. NOT FOR BREATHABLE AIR USE