

Exclusive Quick Click™ Re-Calibration System

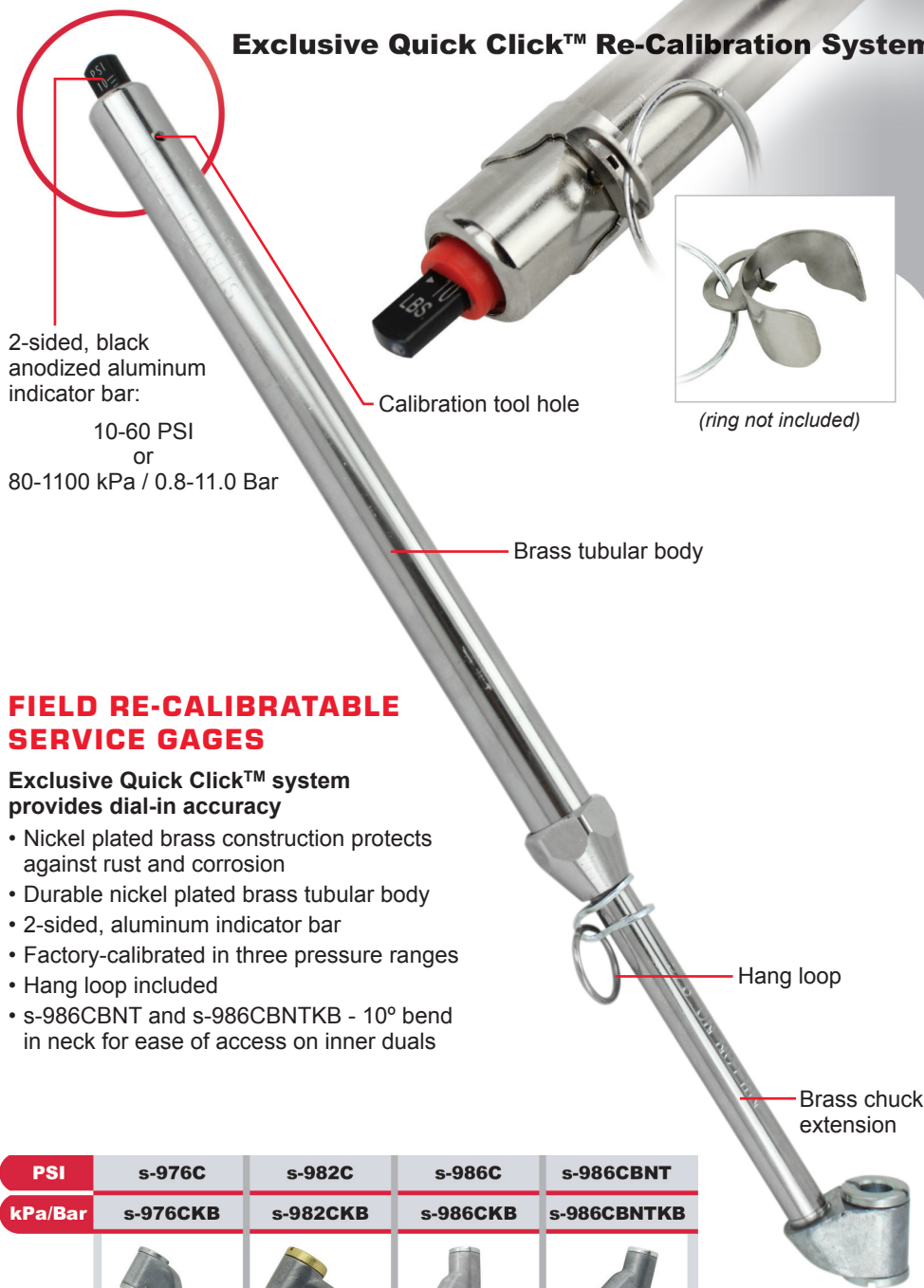

2-sided, black anodized aluminum indicator bar:
10-60 PSI
or
80-1100 kPa / 0.8-11.0 Bar



(ring not included)

FIELD RE-CALIBRATABLE SERVICE GAGES

Exclusive Quick Click™ system provides dial-in accuracy

- Nickel plated brass construction protects against rust and corrosion
- Durable nickel plated brass tubular body
- 2-sided, aluminum indicator bar
- Factory-calibrated in three pressure ranges
- Hang loop included
- s-986CBNT and s-986CBNTKB - 10° bend in neck for ease of access on inner duals

PSI	s-976C	s-982C	s-986C	s-986CBNT
kPa/Bar	s-976CKB	s-982CKB	s-986CKB	s-986CBNTKB
Standard Dual Head	Large Bore Dual Head	Dual Head Straight Foot	Dual Head Straight Foot 10° Bend	



1
Insert Calibration Tool

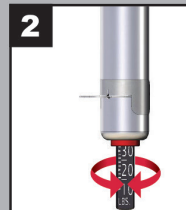

2
Slowly Rotate Indicator Bar Until Tool is Engaged

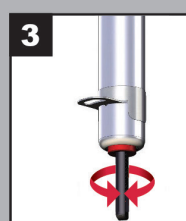

3
Turn Indicator Bar to Adjust
1 Click = 0.25 PSI



4
Remove Tool When Done

COUPLERS
PLUGS
CAM/GROOVE

HOSE
HOSE REELS
FITTINGS

BLO-GUNS

FRLS

PUSH-TO-CONNECT

INFLATOR GAGES

PRESSURE &
SERVICE GAGES

GREASE GUNS

MERCHANDISERS

EXTENDED REACH DIAL TYPE TIRE GAGES



- Internal diaphragm construction for greater durability**
- 12" length extended reach hose
 - Dual head chuck w/ deflator valve
 - Durable rubber boot

Retail Part No.	Per Card	PSI		kPa		Tire Tread Depth Gage
		Range	Increments	Range	Increments	
s-935	1	0 to 60	2 PSI	0 to 400	20 kPa	No
s-936	1	0 to 160	5 PSI	0 to 1100	20 kPa	

HEAVY DUTY EXTENDED REACH DIAL TYPE TIRE GAGES



- 9" extension with straight large bore chuck comes with cushioned grip**
- Internal diaphragm construction for greater durability
 - Durable rubber boot

Retail Part No.	Per Card	Chuck Type	Hose Length	Overall Extended Length	PSI		kPa	
					Range	Increments	Range	Increments
951	1	12" Dual Head, Straight Foot	10.5"	22.5"	0 to 160	5 PSI	0 to 1100	20 kPa
956	1	9" Straight Large Bore		14"				

SERVICE GAGES



Provide accurate, long life, trouble-free performance

- Nickel plated brass tubular body and 4-sided nylon indicator bars
- 2 sides of indicator bar in PSI, 2 sides in kPa
- 10-160 PSI (2 lb increments) / 80-1100 kPa (20 kPa increments)
- Calibrated in three ranges before leaving factory
- Hang loop included
- 986BNT - 10° bend in neck for ease of access for dualities

Bulk Part No.	Retail Part No.	Per Card	Chuck Style	Overall Length
	s-976	1	Standard Dual Head	12-3/4"
	s-982	1	Large Bore Dual Head	13 1/4"
	s-986	1	Dual Head Straight Foot	13"
986BNT	s-986BNT	1	Dual Head Straight Foot	13"

EXELAIR™ HEAVY DUTY DIGITAL TIRE GAUGE



- 360° swivel dual head, straight foot chuck
- Pressure range: 5-100 PSI (measures PSI, kPa and Bar)
- Backlit digital display w/ auto shutoff
- Metal body for durability
- Slip resistant rubber grip
- Built in LED flashlight
- Batteries included

Retail Part No.	Per Card	Chuck Style	Product Specs		
			PSI	kPa	Bar
EX516DIG	1	Dual Head Straight Foot	5-100	1-7	35-800

DIGITAL READ TIRE PRESSURE GAGE



s-99900

Automatic shut off - highly accurate

- Consistent repeatability
- Durable construction

Retail Part No.	Per Card	Pressure Range			CR2032 Battery
		PSI	kPa	Bar	
s-99900	1	2 to 99	15 to 700	0.15 to 7.0	Included



COUPLERS
PLUGS
CAM/GROOVE

HOSE
REELS
FITTINGS

BLO-GUNS

FRLS

PUSH-TO-CONNECT

INFLATOR GAGES

PRESSURE &
SERVICE GAGES

GREASE GUNS

MERCHANDISERS