

## Standard Duty & Specialty Reels

### Low Pressure Air & Water Hose Reels



#### Features for All Standard Duty Air & Water Reels:

- Stamped steel construction with reinforced ribs for increased strength
- The industrial-grade drive spring is protected from the environment
- Stainless steel torsion spring is used on the latch to insure maximum life
- Steel components are individually powder coated and teamed with composite materials, which virtually eliminates corrosion
- Versatile mounting- the guide arm can be adjusted to seven convenient locations
- Composite spool and steel components make the reel strong yet lighter

Model	Hose W x L	Max. PSI	Inlet	Outlet	Dimensions
1496NS	1/4" x 25'	300 PSI	3/8" NPT (F)	1/4" NPT (M)	A
1497NS	3/8" x 25'	300 PSI	3/8" NPT (F)	1/4" NPT (M)	A
1458NS	3/8" x 50'	300 PSI	1/2" NPT (F)	1/2" NPT (M)	B

Dimensions	Bolt Pattern	Height	Width
A	2.250" x 6.000"	17.875"	5.750"
B	2.250" x 6.000"	17.875"	6.250"

### Portable Closed Reel for Air & Water



#### 1459NS

- 3/8" x 50' Reel with Advanced Auto-Stop
- No ratcheting sound
- Working Pressure: 300psi
- Inlet/Outlet: 3/8"
- Hose I.D.: 3/8"
- Hose Length: 50'
- Hose Material: Hybrid Polymer

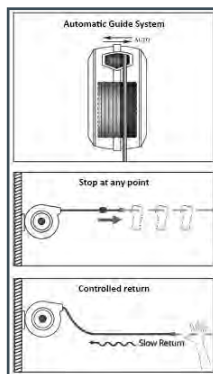

180° Swivel Mount

Compatible With:



### DEF Hose Reel



#### DEF-7925

- 25' x 3/4" NPT hose
- Maximum pressure 250 PSI
- Stainless steel fittings and flow path
- Steel construction
- Weight: 42lbs.

Bolt Pattern: 7.8125" x 3.875"

*Other sizes available upon request.*