

Tube Connectors

Part No.	Style	A	B	Type
66200	1	¼" O.D.	⅛" NPT	STGT
66201	1	¼" O.D.	⅛" NPT	90°
66414	2	⅙" O.D.	⅛" NPT	90°
66415	2	⅙" O.D.	⅛" NPT	STGT
66714	2	⅙" O.D.	¼"-28 thd.	STGT
66716	2	⅙" O.D.	¼"-28 thd.	90°



Compression Nut

No. 66260 for use with Style 2 Tube Connectors and 66717 Swivel.
For ⅙" O.D. Tubing. Thread size is ⅝"-24.



Sleeve

No. 68462 for use with Style 1 Tube Connectors. For ¼" O.D. Tubing.



Nut

No. 68464 for use with Style 1 Tube Connectors. For ¼" O.D. Tubing.

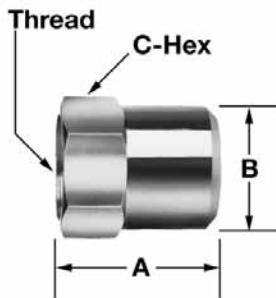

Zerk-Lock® Grease Fitting Adapter

Connects any ⅙" NPTF male tube adapter directly to a standard grease fitting. Aluminum, carbon steel construction; fluorocarbons elastomer seal. Useful for connecting to drive-type fittings or metric fittings. Once installed, the Zerk-Lock cannot be removed from the fitting.

Part No.	Threads in. / mm	A in./mm	B in./mm	C in./mm
270784	⅙" NPSL Female	.625 / 15.9	.500 / 12.7	.500 / 12.7

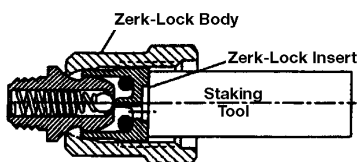

Installation Accessories



No. 247615 Staking Tool

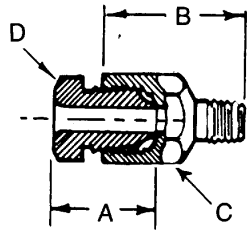

Threaded Sleeve Tube Fittings—Straight

Tube to male thread. For feed lines. Carbon steel with brass nut unless noted (*) otherwise.

Part No.	Tube O.D. in.	Thread in.	A in.	B in.	Hex. C in.	Hex. D in.	Working Press. psig / bar
66771	1/8	10-32	1/2	11/16	3/8	5/16	500 / 34
66714	1/8	1/4-28	1/2	5/8	3/8	5/16	500 / 34
* 66714-9	1/8	1/4-28	1/2	5/8	3/8	5/16	500 / 34
66772	1/8	1/4-28	1/2	11/16	3/8	5/16	500 / 34
66730	1/8	5/16-32	1/2	11/16	3/8	5/16	500 / 34
66773	1/8	3/8-24	1/2	11/16	7/16	5/16	500 / 34
66415	1/8	1/8 NPTF	1/2	5/8	7/16	5/16	500 / 34

* 303 Stainless Steel

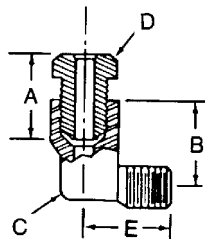

Threaded Sleeve Tube Fittings—90° Elbow

Tube to male thread. For feed lines. Brass with brass nut unless noted (*) otherwise.

Part No.	Tube O.D. in.	Thread in.	A in.	B in.	Flats C in.	Hex. D in.	E in.	Working Press. psig / bar
66716	1/8	1/4-28	1/2	1/2	13/32	5/16	33/64	500 / 34
66414	1/8	1/8 NPTF	1/2	1/2	7/16	5/16	21/32	500 / 34

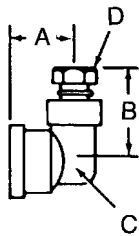

Threaded Sleeve Tube Fittings—90° Elbow

Tube to female pipe thread. For feed lines. Brass with brass nut unless noted (*) otherwise.

Part No.	Tube O.D. in.	Pipe Thd. in.	A in.	B in.	Flats C in.	Hex. D in.	Working Press. psig / bar
66935	1/8	1/8 NPT	23/32	11/32	3/8	5/16	500 / 34

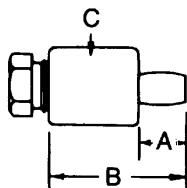

Threaded Sleeve Tube Fittings—Drive-Type

For feed lines. Steel body with brass nut.

Part No.	Hole Size in.	Tube O.D. in.	A in.	B in.	Dia. C in.	Hex. D in.	Working Press. psig / bar
82092	3/16	1/8	13/64	45/64	7/16	5/16	500 / 34

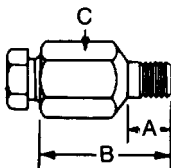

Threaded Sleeve Tube Fittings—Spin-Drive Type

For feed lines. Steel body with brass nut.

Part No.	Hole Size in.	Tube O.D. in.	A in.	B in.	Hex. C in.	Hex. D in.	Working Press. psig / bar
82093	1/4	1/8	5/32	5/8	7/16	5/16	500 / 34

Threaded Sleeve Tube Fittings—Compression Nuts

For feed lines. Brass unless noted (*) otherwise.

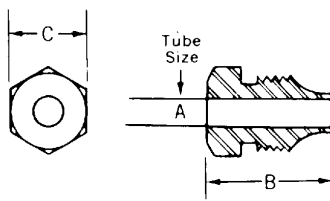

Part No.	A Tube Size O.D. in.	B in.	C in.	Working Press. psig / bar
66260	1/8	1/2	5/16	500 / 34
* 66260-9	1/8	1/2	5/16	500 / 34
66713	1/4	5/8	7/16	500 / 34