

***91400B UPDATED UNIVERSAL OHC VALVE SPRING COMPRESSOR** PATENT PENDING Actuate the compression tube even in tight confined locations like under the cowl where the lever cannot be moved, or may not even fit. By adding the ability to separate the lever from the compression tube anywhere along the bar, you can compress the springs that are confined by brake boosters, or other factors by locating the lever along the bar where there is open space.
Applications: All vehicles



*See Replacement Parts Page 43-44 *See Update Kit Page 31

91400B-LDT VALVE SPRING LOCK DOWN TOOL

Developed to aid the technician when using the 91400B to remove and re-install valve springs. In operation, it locks the compressor bucket down on the retainer allowing both hands free to remove and re-install the keeper.

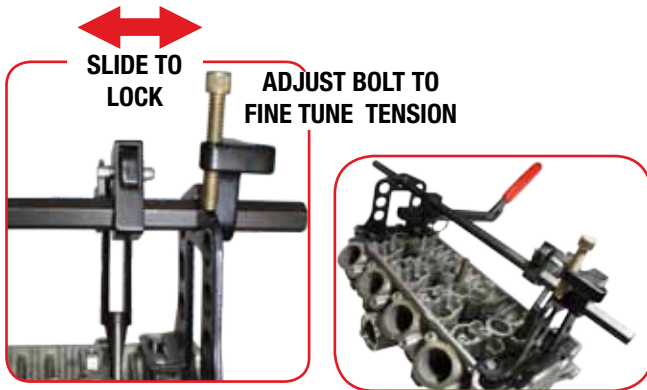

91410B UPDATE KIT Updates 91400A to 91400B
The update kit includes: Hex bar, two hex slider blocks, three detent clevis pins and a short lever bar.



91900 RADIATOR DRAIN PLUG SOCKET Snaps onto a 3/8" square drive extension allowing it to reach into confined areas. It also features a double slotted end that captures the thumb wings to turn the drain plug open or closed.
Applications: most Import and Domestic cars.

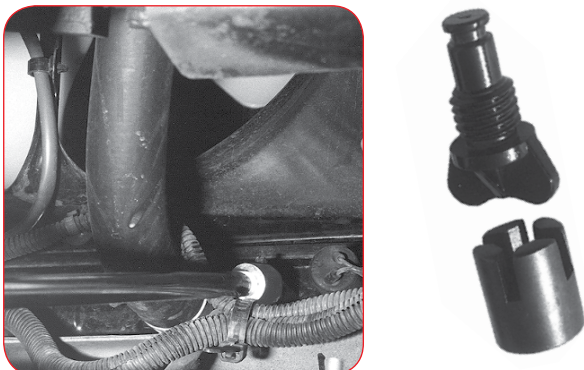

92350 NARROW ACCESS VALVE STEM SEAL REMOVAL PLIERS Remove the valve stem seals used on most overhead camshaft engines. These pliers feature "gripping" serrations in the tip allowing them to grasp both original equipment and aftermarket seals regardless of their configuration. The pliers are made from quality heat-treated steel and come with easy grip handles.



FAN CLUTCH KITS

61200 TWO PIECE KIT U.S. PATENT 6,912,936

This kit (61600 & 95210) has a specially designed contoured water pump holder that is exceptionally easy to use on vehicles using bolt-on water pump pulleys to remove and replace the viscous fan clutch. There are many sizes and patterns of the bolts holding the pulley on the water pump. The new water pump holding tool replaces all designs of water pump holding tools for "bolt-on type pulleys". Simply with only one hand, hook on the pulley bolt and hold to remove the viscous fan clutch. Reverse the 61600 to install the fan clutch.

Applications: Chrysler, GM, Ford, Land Rover and Mazda (Not including the 4.9L 6 cylinder Ford).



61600 see page 16

95210 see page 28

61260 THREE PIECE KIT U.S. PATENT 6,912,936

This three piece kit (includes 61600, 95210 & 95260) gives the professional technician the ability to service all fan clutches that have bolt-on pulleys on the water pump.

Applications: Chrysler, GM, Ford, Land Rover and Mazda applications. (Includes the 4.9L 6 cylinder Ford). Used on water pump pulleys that are bolted-on



61600 see page 16

95210 see page 28

95260 see page 29

UPDATE KITS

13351 Updates the 64900 or 64900A to 13350. Update kit includes three legs and 6 spring washers



13350 CAMARO 3.6L HARMONIC DAMPER PULLEY PULLER

See Page 11

13451 Updates the 64900 or 64900A to 13450. Update kit includes three legs and 6 spring washers



13450 DODGE HARMONIC DAMPER PULLEY PULLER

See Page 11

64910A Updates the 64900 to 64900A. Update kit includes three legs and 6 spring washers



64900A UPGRADED HARMONIC DAMPER PULLEY PULLER KIT

See Page 17

65120 PATENT PENDING HONDA / ACURA BUSHING X-TRACTOR™ "REMOVAL AND INSTALLATION TOOL"
Update for **65100, 65130**



65100 HONDA / ACURA BUSHING X-TRACTOR™

See Page 18

91410B UPDATED UNIVERSAL OHC VALVE SPRING COMPRESSOR

Includes: Hex bar, two hex slider blocks, three detent clevis pins and a short lever bar.

Updates 91400A to 91400B



91400B UPDATED UNIVERSAL OHC VALVE SPRING COMPRESSOR

See Page 27

UNIVERSAL TOOLS

89250 MASTER CYLINDER PRESSURE CAP
See Page 25



See Page 26

90450 UNIVERSAL VALVE ADJUSTMENT TOOL 9/16"
See Page 25



See Page 26

91400B UPDATED UNIVERSAL OHC VALVE SPRING COMPRESSOR



See Page 27

91400B-LDT VALVE SPRING LOCK DOWN TOOL



See Page 27

91900 RADIATOR DRAIN PLUG SOCKET



See Page 27

92350 NARROW ACCESS VALVE STEM SEAL REMOVAL PLIERS



See Page 27

93750B OFFSET 2 1/8" SUPER DUTY 12 & 6 POINT OXYGEN SENSOR WRENCH



See Page 28

94170A BELT IT SERPENTINE, V-BELT AND TIMING BELT INSTALLATION ASSIST



See Page 28

96600 UNIVERSAL HOSE PLIERS 1/2" TO 3/4"



See Page 29

98110 RELAY AND FUSIBLE LINK SLIP JOINT PLIERS



See Page 30

GM

11700 DURAMAX LB7 INJECTOR PULLER KIT



See Page 8

12150 DURAMAX FUEL RAIL PRESSURE WRENCH



See Page 8

12400 DURAMAX TURBO VANE POSITION SENSOR SOCKET



See Page 9

12900 21mm and 24mm ALIGNMENT WRENCH

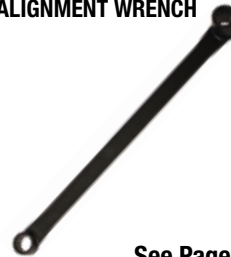

See Page 9

13100 GM DURAMAX WATER IN FUEL SENSOR WRENCH



See Page 10

13300 DURAMAX LLY, LBZ, LMM INJECTOR PULLER KIT



See Page 10

13350 CAMARO 3.6L HARMONIC DAMPER PULLEY PULLER



See Page 11

14300 DURAMAX FAN PULLEY HOLDER



See Page 13

15500, 15510, 15520 NOX AND SOOT SENSORS



See Page 14

61500B FAN CLUTCH WRENCH



See Page 16, 28, 32

61600 FAN CLUTCH WRENCH



See Page 15, 16, 28, 29, 31, 32

62800 GM HARMONIC DAMPER HOLDING TOOL



See Page 16

64900A UPGRADED HARMONIC DAMPER PULLEY PULLER



See Page 11, 17, 31

66200 GM DOOR BUSHING INSTALLATION TOOL



See Page 19

69200 GM DURAMAX CRANKSHAFT AND FLYWHEEL KIT



See Page 22

REPLACEMENT PARTS

12200	VW/ AUDI INJECTOR PULLER
400-1400-87-G	SNAP RING 7/8 EXTERNAL
270-8mm	ACORN NUT

13350	CAMARO 3.6L HARMONIC DAMPER PULLEY PULLER
97400-1-T	PULLEY PULLER HUB
13350-1	PULLEY PULLER LEG FOR GM
97400-3-T	CENTER BOLT
97400-5-T	CLEVIS PIN
97400-6	PULLEY PULLER PUSH ROD 4.0"
97400-4	PULLEY PULLER PUSH ROD 5.5"
97400-7	PULLEY PULLER PUSH ROD 7.5"
64900-8	PULLEY PULLER PUSH ROD 6.5"
64900-0-T	BLOW MOLDED BOX

13450	DODGE 5.7 & 3.5L HARMONIC DAMPER PULLEY PULLER
97400-1-T	PULLEY PULLER HUB
13450-1	PULLEY PULLER LEG DODGE 5.7L
97400-3-T	CENTER BOLT
97400-5-T	CLEVIS PIN
97400-6	PULLEY PULLER PUSH ROD 4.0"
97400-4	PULLEY PULLER PUSH ROD 5.5"
97400-7	PULLEY PULLER PUSH ROD 7.5"
64900-8	PULLEY PULLER PUSH ROD 6.5"
64900-0-T	BLOW MOLDED BOX

63800	TOYOTA / LEXUS / MAZDA / NISSAN CAM SEAL INSTALLER
63800-1	CAM SEAL INSTALLER CUP
63800-2	2.50" LONG 1/2X20 - M12X1.25 SET SCREW
63800-3	2.50" LONG 1/2X20 - M10X1.25 SET SCREW
200-1/2-20	HEX NUT
300-1/2 ID	WASHER

64900A	HARMONIC DAMPER PULLEY PULLER
97400-1-T	PULLEY PULLER HUB
64900A-1	PULLEY PULLER ARM (SILVER)
97400-3-T	CENTER BOLT

64900A	HARMONIC DAMPER PULLEY PULLER
97400-5-T	CLEVIS PIN
97400-6	PULLEY PULLER PUSH ROD 4.0"
97400-4	PULLEY PULLER PUSH ROD 5.5"
97400-7	PULLEY PULLER PUSH ROD 7.5"
64900-8	PULLEY PULLER PUSH ROD 6.5"
64900-0-T	BLOW MOLDED BOX

65100 & 65130	HONDA / ACURA BUSHING X-TRACTOR™
65100-1-MA	CUP
65100-9	PULLER ASSEMBLY
65100-5-T	BOLT WITH TIP
65120	ACURA INTEGRA ADAPTER (65130 only)
65100-0-T	BLOW MOLDED BOX
65110	REPLACEMENT CABLE
64900-0-T	BLOW MOLDED BOX

65510	TOYOTA/LEXUS CAM SEAL R&R TOOL
65500-2	REMOVER CUP
63800-2	THREADED STEP STUD
65500-4-MA-C	REMOVAL STUD
63800-1	INSTALLER CUP
200-1/2-20	HEX NUT
300-1/2 ID	WASHER
65510-0-TR	BLOW MOLDED BOX

67600	VW / AUDI TIMING BELT PULLEY HOLDER
150-M8X1.25X35	BOLT M8X1.25X35
350-8mm	WASHER 8mm

67650	VW / AUDI TIMING BELT TENSIONER RELEASE TOOL
97300-5	LOCK PIN

68100	HONDA/ACURA FRONT LOWER COMPLIANCE BUSHING TOOL
68100-2	BUSHING R&R PISTON
68100-5-C	BOLT 14mm 2.0X9"
68100-6-C	BUSHING R&R 59mm CUP
68100-7-C	BUSHING R&R 74mm CUP
68100-8-C	NUT 14 mm 2.0X45mm
68100-0-T	BLOW MOLDED BOX
68100BK	BOLT AND NUT KIT

86100B	UNIVERSAL BRAKE CALIPER KIT
85250-1	STUD 7/8 - 9 X 6"
85250-2	RETAINING "C" RING FOR STUD
85250-3	1/4" PLATE
85250-4	NUT 7/8" - 9 X 3"
85250-5	SNAP RING 1-1/8"
85250-7	ADAPTER #1
85250-8	ADAPTER #2
85250-9A	ADAPTER #3
85250-10	ASSEMBLED MAIN BODY (INCLUDES 85250-1 THROUGH 85250-5)
86150-4	ADAPTER #4
86150-5	ADAPTER #5
86150-6	ADAPTER #6
86100B-7	ADAPTER #7

91400B	UNIVERSAL VALVE SPRING COMPRESSOR
91400B-1-C	HEX MAIN BAR
91400-2	STAND (2 required)
91400-2A	DEPRESSING TUBE
91400-3A	ARM
91400-4-C	DOUBLE HEX SLIDE (2 required)
91400-5-C	SMALL LEVER ARM
91400A-0-TR	BLOW MOLDED BOX
500-1/4X1	CLEVIS PIN (3 required)

97300	TIMING BELT TENSIONER
97300-5	LOCK PIN