

1/2" DRIVE IMPACT SOCKETS - 8 POINT

- ▶ Drive end chamfer and four detents help provide quick positive engagement with drive tool on any of the socket drive walls.
- ▶ Tight tolerances for snug fit on fastener.
- ▶ Large clearance holes, concentric opening and nut end chamfer make it easy to position socket on fasteners.
- ▶ Made from high-strength steel to help minimize wall thickness and provide access to fasteners in recesses and where nuts and bolts protrude.
- ▶ Impact sockets are used wherever powered drive tools are used to install or remove fasteners.
- ▶ Impact sockets are designed to withstand higher torque and force associated with impact tools in repetitive application.
- ▶ Proto® 8 Point Impact Sockets are ideal for use on stubborn or damaged fasteners, and also on fasteners made from soft materials.
- ▶ Socket size stamped on tool for easy identification.
- ▶ Side locking hole.

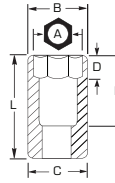

- ▶ Radius-corner socket design
- ▶ Engages flats for better grip
- ▶ Improves the ability to turn worn or rounded fasteners

INCH	8	Nut End Outside Diameter (in) (B)	Drive End Outside Diameter (in) (C)	Nut Depth (in) (D)	Bolt Clearance Depth (in) (E)	Overall Length (in) (L)	Weight (lbs)
3/8	J7412S	47/64	15/16	17/64	27/32	1-1/2	0.17
7/16	J7414S	53/64	15/16	19/64	27/32	1-1/2	0.18
1/2	J7416S	15/16	15/16	11/32	27/32	1-1/2	0.18
9/16	J7418S	1-1/32	1-1/32	3/8	27/32	1-1/2	0.21
5/8	J7420S	1-1/8	1-1/8	27/32	27/32	1-1/2	0.26
11/16	J7422S	1-3/16	1-3/16	27/32	27/32	1-1/2	0.27
3/4	J7424S	1-11/32	1-11/32	27/32	27/32	1-1/2	0.37
13/16	J7426S	1-3/8	1-3/8	27/32	27/32	1-1/2	0.39
7/8	J7428S	1-1/2	1-1/2	31/32	31/32	1-5/8	0.48
15/16	J7430S	1-5/8	1-5/8	1-1/64	1-3/32	1-3/4	0.62
1	J7432S	1-3/4	1-3/4	1-1/64	1-3/32	1-3/4	0.74
1-1/16	J7434S	1-27/32	1-27/32	1-1/64	1-11/32	1-3/4	0.91

ASME B107.110-2012

8 PT IMPACT SOCKETS

Sometimes called "double square sockets", 8 point sockets gives the mechanic twice the angles of attack when trying to fit a socket over a 4 point fastener.

These fasteners are often found in heavy industry or agricultural equipment, especially older units; but even these older standards can be found on modern equipment. 4 Point fasteners can also be found on square pipe plugs, transmission drains, fill plugs on hydraulic tanks, adjusters for drum brakes, square-headed cylinder bolts, and various taps.

Normally, 4 point sockets are recommended for 4 point fasteners, but they give you only four opportunities to seat the socket over the fastener - north, east, south, and west.

An 8 point socket doubles the numbers, allowing a mechanic to reach a socket in between the other angles. With an 8 point socket, there is still plenty of contact with the fastener to get a firm grip on the head.

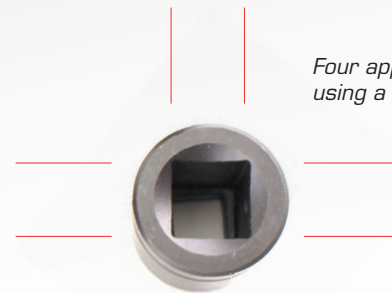

Four approaches using a 4 PT socket.



Eight approaches using a 8 PT socket.