



**LIFETIME
WARRANTY**

Backed by a Lifetime Warranty, Sunex Impact Sockets are warranted against defects in materials and workmanship for the life of the product. This warranty does not apply to items that have been misused, abused, altered in any way, or worn out from use. Some Adapters, Reducers, and Extra Thin Wall Impact Sockets are sold with out of box warranty.

IMPACT SOCKETS

Since 1984, we've led the market with our solution-based designs and quality materials. All of our Impact Sockets (low-profile, standard, deep, hex drivers, universal joint, specialty, and extensions/adapters) are backed by an industry-leading warranty, so you can rest easy knowing your sockets are guaranteed to perform.

IMPACT SOCKETS

HIGHEST QUALITY. HIGHEST STANDARDS.

RADIUSED CORNERS

Focuses impact on fastener's flat surfaces, increasing torque and reducing wear and rounding to the fastener.

DURABLE CR-MO STEEL

Precision manufactured with chrome-molybdenum steel for high-impact applications.

HEAT TREATED / TEMPERED

Sockets are first heat treated to increase hardness and then tempered to maximize durability.



METRIC

SAE

1/4"
DRIVE

3/8"
DRIVE

1/2"
DRIVE

3/4"
DRIVE

1"
DRIVE

SPECIALTY SOCKETS

Every job has its own challenges. We offer a wide selection of specialty sockets to handle anything the job calls for.

NO-SKIP SIZE SPECTRUM

Sunex Impact Socket Sets include every size in the specification range: Largest to smallest, and everything in between.

1/4" DRIVE INDIVIDUAL SAE SOCKETS

SIZE	STANDARD	DEEP	UNIVERSAL	MAGNETIC	DEEP MAGNETIC
SAE	MODEL	MODEL	MODEL	MODEL	MODEL
3/16"	806	806D	806U	806MG	806DMG
7/32"	807	807D	807U	807MG	807DMG
1/4"	808	808D	808U	808MG	808DMG
9/32"	809	809D	809U	809MG	809DMG
5/16"	810	810D	810U	810MG	810DMG
11/32"	811	811D	811U	811MG	811DMG
3/8"	812	812D	812U	812MG	812DMG
7/16"	814	814D	814U	814MG	814DMG
1/2"	816	816D	816U	816MG	816DMG
9/16"	818	818D	818U	818MG	818DMG

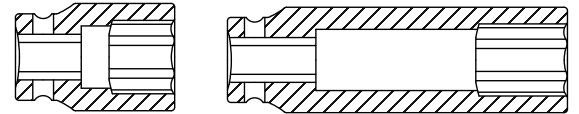

Standard

Deep

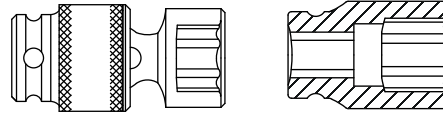

Universal

Magnetic



Deep Magnetic

1/4" DR.

1/4" DRIVE INDIVIDUAL METRIC SOCKETS

SIZE	STANDARD	DEEP	UNIVERSAL	MAGNETIC	DEEP MAGNETIC	12 PT. MAG UNIVERSAL
METRIC	MODEL	MODEL	MODEL	MODEL	MODEL	MODEL
4mm	804M	804MD	804UM	804MMG	804MDMG	
4.5mm	8045M	8045MD	8045UM	8045MMG	8045MDMG	
5mm	805M	805MD	805UM	805MMG	805MDMG	805ZUMMG
5.5mm	8055M	8055MD	8055UM	8055MMG	8055MDMG	
6mm	806M	806MD	806UM	806MMG	806MDMG	806ZUMMG
7mm	807M	807MD	807UM	807MMG	807MDMG	807ZUMMG
8mm	808M	808MD	808UM	808MMG	808MDMG	808ZUMMG
9mm	809M	809MD	809UM	809MMG	809MDMG	809ZUMMG
10mm	810M	810MD	810UM	810MMG	810MDMG	810ZUMMG
11mm	811M	811MD	811UM	811MMG	811MDMG	811ZUMMG
12mm	812M	812MD	812UM	812MMG	812MDMG	812ZUMMG
13mm	813M	813MD	813UM	813MMG	813MDMG	813ZUMMG
14mm	814M	814MD	814UM	814MMG	814MDMG	814ZUMMG
15mm	815M	815MD	815UM	815MMG	815MDMG	815ZUMMG

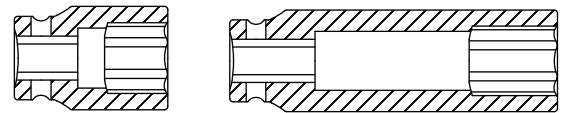

Standard

Deep

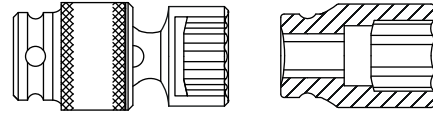

Universal

Magnetic

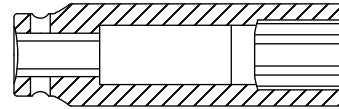

Deep Magnetic

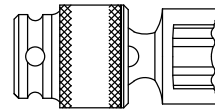

12 pt. Magnetic Universal

1/4" DR. UNIVERSAL MAGNETIC 12 POINT METRIC

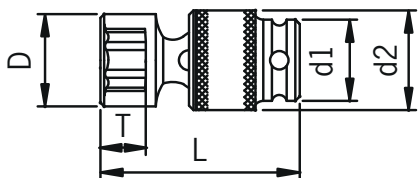

ITEM	SIZE	D	T	D1	D2	L
806ZUMMG	6mm	10.0	8	13	18.0	10.0
807ZUMMG	7mm	11.5	8	13	18.0	11.5
808ZUMMG	8mm	12.5	8	13	18.0	12.5
809ZUMMG	9mm	14.0	8	13	18.0	14.0
810ZUMMG	10mm	15.0	8	13	18.0	15.0
811ZUMMG	11mm	16.5	8	13	18.0	16.5
812ZUMMG	12mm	16.8	8	13	20.0	16.8
813ZUMMG	13mm	18.8	8	13	20.0	18.8
814ZUMMG	14mm	19.8	8	13	20.0	19.8
815ZUMMG	15mm	20.8	8	13	20.8	20.8

1/4" DR. UNIVERSAL 6 POINT SAE

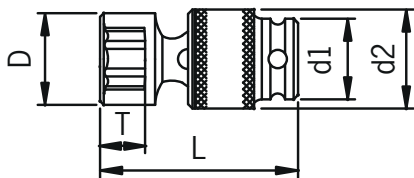

ITEM	SIZE	D	T	D1	D2	L
806U	3/16"	18	8	8.4	20	43
807U	7/32"	18	8	9.4	20	43
808U	1/4"	10.3	8	13	20	45
809U	9/32"	18	8	11.3	20	43
810U	5/16"	12.5	10	13	20	45
811U	11/32"	18	10	13.8	20	43
812U	3/8"	15	10	13	20	45
814U	7/16"	16.5	10	13	20	45
816U	1/2"	18.8	10	13	20	49
818U	9/16"	19.8	10	13	20	49

1/4" DR. UNIVERSAL 6 POINT METRIC

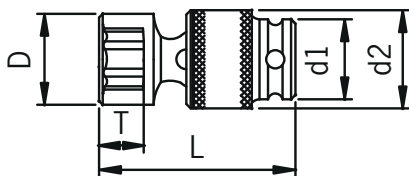

ITEM	SIZE	D	T	D1	D2	L
804UM	4mm	18.0	6	7.5	20	43
8045UM	4.5mm	18	8	8.1	20	43
805UM	5mm	8.8	8	13	20	45
8055UM	5.5mm	9.5	8	13	20	45
806UM	6mm	10	8	13	20	45
807UM	7mm	11.5	10	13	20	45
808UM	8mm	12.5	10	13	20	45
809UM	9mm	14	10	13	20	45
810UM	10mm	15	10	13	20	45
811UM	11mm	16.5	10	13	20	45
812UM	12mm	16.8	10	13	20	49
813UM	13mm	18.8	10	13	20	49
814UM	14mm	19.8	10	13	20	49
815UM	15mm	20.8	10	13	20	49