

Standard



Deep

1" DRIVE SAE INDIVIDUAL SOCKETS

SIZE	STANDARD	DEEP	SIZE	STANDARD	DEEP
SAE	MODEL	MODEL	SAE	MODEL	MODEL
3/4"	524	524D	2-1/4"	572	572D
13/16"	526	526D	2-5/16"	574	574D
7/8"	528	528D	2-3/8"	576	576D
15/16"	530	530D	2-7/16"	578	578D
1"	532	532D	2-1/2"	580	580D
1-1/16"	534	534D	2-9/16"	582	582D
1-1/8"	536	536D	2-5/8"	584	584D
1-3/16"	538	538D	2-11/16"	586	586D
1-1/4"	540	540D	2-3/4"	588	588D
1-5/16"	542	542D	2-13/16"	590	590D
1-3/8"	544	544D	2-7/8"	592	592D
1-7/16"	546	546D	2-15/16"	594	594D
1-1/2"	548	548D	3"	596	596D
1-9/16"	550	550D	3-1/8"	5100	5100D
1-5/8"	552	552D	3-1/4"	5104	5104D
1-11/16"	554	554D	3-3/8"	5108	5108D
1-3/4"	556	556D	3-1/2"	5112	5112D
1-13/16"	558	558D	3-5/8"	5116	5116D
1-7/8"	560	560D	3-3/4"	5120	5120D
1-15/16"	562	562D	3-7/8"	5124	5124D
2"	564	564D	4"	5128	5128D
2-1/16"	566	566D	4-1/8"	5132	5132D
2-1/8"	568	568D	4-1/4"	5136	5136D
2-3/16"	570	570D	4-1/2"	5140	5140D

1" DR. STANDARD 6 POINT SAE

ITEM	SIZE	SHAPE	D	D	T1	T2	L1	L
526	13/16"	A	38	51				58
524	3/4"	A	36	51	17	31	33	58
528	7/8"	A	39	51	17	31	33	58
530	15/16"	A	40	51	17	31	33	58
532	1"	A	42	51	17	31	33	58
534	1-1/16"	A	44	51	17	31	33	58
536	1-1/8"	A	46	51	17	31	33	58
538	1-3/16"	A	48	51	19	31	33	60
540	1-1/4"	B	/	51	19	31	/	60
542	1-5/16"	C	53	52	21	31	30	62
544	1-3/8"	C	54	52	21	31	30	62
546	1-7/16"	C	56	52	21	31	30	62
548	1-1/2"	C	58	52	21	31	30	62
550	1-9/16"	C	60	52	21	31	30	62
552	1-5/8"	C	61.5	52	21	31	30	62
554	1-11/16"	C	65	52	23	31	30	64
556	1-3/4"	C	66	58	23	36	30	64
558	1-13/16"	C	68	58	23	36	30	64
560	1-7/8"	C	70	58	25	36	30	66
562	1-15/16"	C	72	58	27	36	30	68
564	2"	C	74	58	29	36	30	70
566	2-1/16"	C	75	58	29	36	30	70
568	2-1/8"	C	78	58	29	36	30	70
570	2-3/16"	C	80	62	32	35	30	72
572	2-1/4"	C	84	62	34	35	30	75
574	2-5/16"	C	86	62	34	35	30	75
576	2-3/8"	C	87	62	35	38	30	78
578	2-7/16"	C	89	62	35	38	30	78
580	2-1/2"	C	91	62	36	40	30	80
582	2-9/16"	C	93	62	36	40	30	80
584	2-5/8"	C	95	62	38	40	33	82
586	2-11/16"	C	97	62	38	40	33	82
588	2-3/4"	C	98	62	40	40	33	85
590	2-13/16"	C	100	62	40	42	33	87
592	2-7/8"	C	102	62	40	42	33	87
594	2-15/16"	C	104	86	48	42	38	95
596	3"	C	106	86	52	40	38	98
5100	3-1/8"	C	109	86	52	42	38	100
5104	3-1/4"	C	113	86	52	42	38	100
5108	3-3/8"	C	115	86	52	42	38	100
5112	3-1/2"	C	119	86	55	44	38	105
5116	3-5/8"	C	127	86	55	32	20	105
5120	3-3/4"	C	130	86	55	32	20	105
5124	3-7/8"	C	136	86	55	32	20	105
5128	4"	C	140	86	55	32	20	105
5132	4-1/8"	C	143	86	55	32	20	105
5136	4-1/4"	C	146	86	55	32	20	105
5140	4-1/2"	C	152	86	55	32	20	105

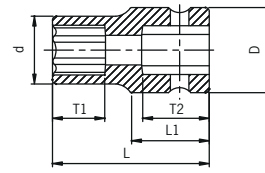

A

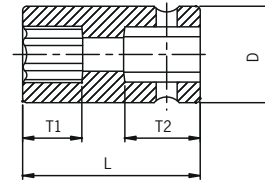

B

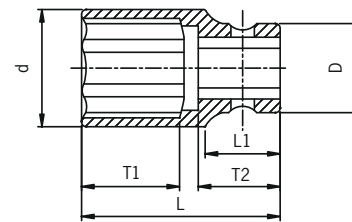

C