

# WIRING INSTRUCTIONS

<b>TITLE</b>	<b>SAWZALL</b>	<b>BULLETIN</b>
MILWAUKEE ELECTRIC TOOL CORP. 13135 WEST LISBON RD. BROOKFIELD, WIS.	DATE Sept. 2011	<b>58-01-0291</b>

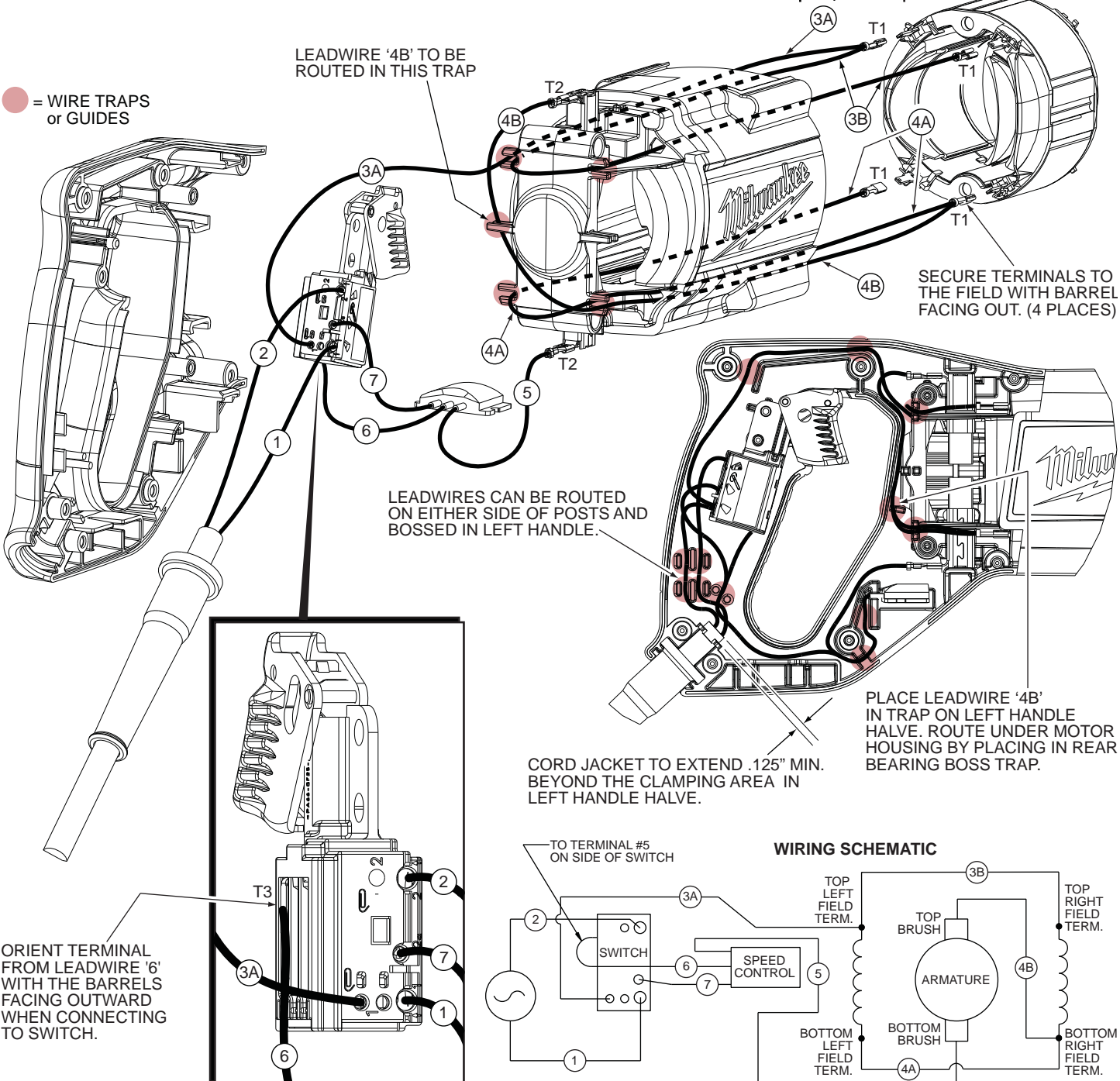

## WIRING SPECIFICATIONS

Wire No.	Wire Color	Origin or Gauge	Length	Terminals, Connectors and 1 or 2 End Wire Preparation
1	White	Cordset	3-1/4"	Strip 5/16" and tin. Connect to '1↑' on switch.
2	Black	Cordset	3-3/4"	Strip 5/16" and tin. Connect to '2↑' on switch.
3A	White	23-94-0520	-----	From the top left field position, connect tinned end to '1' on switch.
3B	White	23-94-0520	-----	From top left field position, connect terminal to top right field position.
4A	Black	23-94-0510	-----	From bottom right field position, connect terminal to bottom left field position.
4B	Black	23-94-0510	-----	From the bottom right field position, connect terminal to top brush.
5	Black or Blue	Remote Mod.	-----	Component of 14-20-3155. Connect to bottom brush.
6	Black or Yellow	Remote Mod.	-----	Component of 14-20-3155. Connect to '5' on right side of switch.
7	Black	Remote Mod.	-----	Component of 14-20-3155. Connect tinned end to '2a' on switch.

**BULK LEAD WIRE - BULLETIN NO. 58-01-0003**

**NOTE:**  
All leads must be held to  $\pm 1/8"$ .  
All lead lengths are before stripping.

TERMINAL DESCRIPTION		
Code	Part No.	Qty.
T1	23-94-1060	4
T2	23-94-0017	2
T3	23-94-0010	1