



TO INFORM YOU

PRODUCT  
SUPPORT  
BULLETIN # 481

TO: AUTHORIZED *portable electric tool* SERVICE STATIONS  
*factory* SERVICE / SALES SUPPORT BRANCH

DATE: April, 2008

TOOL(S) \ PRODUCT(S) AFFECTED: 4004, 4004-4, 4004-55, 4005, 4005-4, 4005-55, 4096, 4096-4,  
4096-55, 4092-20, 4097-20 Internal Clutch Diamond Coring Motors

**SUBJECT: Special Service Tool - Water Seal Jig 61-30-0061**



**CLUTCH MODELS**

Water Seal Jig - 61-30-0061 aides in installing Water Seal(s) 45-06-0635 into Water Swivel Housing 43-76-0051 of Diamond Coring Motors having an Internal Clutch.

This fixture has two [2] machined Stages...



**Stage 1**

used to press water seal flush to the outside edge of the Water Swivel Housing 43-76-0051 (Bit Side) - **Seal #1**.

**Stage 2**

used to press water seal sub-flush to the inside edge of the Water Swivel Housing 43-76-0051 (Gearcase Side) - **Seal #2**.

SEE INSTRUCTIONS ON REVERSE SIDE

This bulletin is for informational purposes. PLEASE NOTE ON SERVICE PARTS LIST: 54-16-4093, 54-16-4125, 54-16-4150, 54-16-5000, 54-16-5001, 54-16-5180, 55-16-5000, 55-16-5001, 55-16-5061, 55-16-5180, 55-16-5181, 55-16-7000, 55-16-7001, 55-16-7025, 55-16-7026, 55-16-7051

apply a thin coat of Type "J" Grease 49-08-4220 to the seal face surface of Stage 1 and Stage 2 prior to placing Water Seal onto jig



Stage 1



Stage 2



Bit Side

Seal # 1  
45-06-0635

Water Swivel Housing  
43-76-0051



Gearcase Side

Seal # 2  
45-06-0635

Water Swivel Housing  
43-76-0051

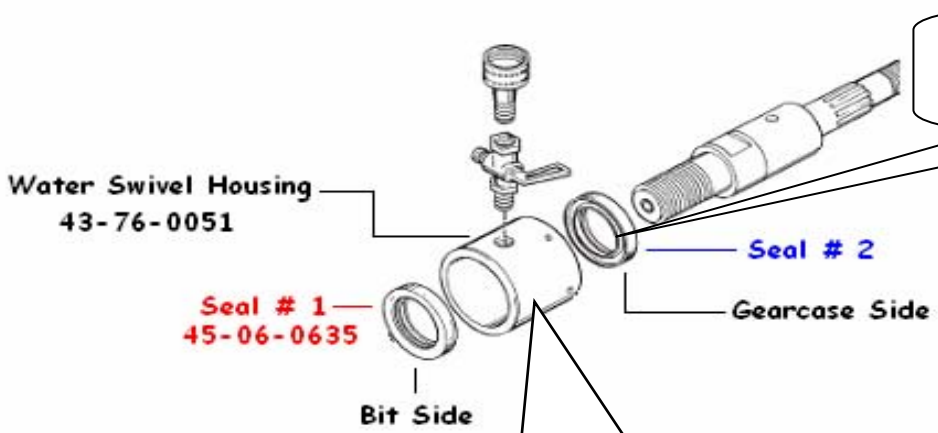

Water Swivel Housing  
43-76-0051

Seal # 1  
45-06-0635

Bit Side

Seal # 2

Gearcase Side

note: flared lips of both seals to face center of water swivel housing when properly installed

after new water seals have been installed into the Water Swivel Housing, it's recommended special service fixture **Seal Guide - 61-40-1100** be used when installing Water Swivel Housing Assembly 43-76-0051 onto the Gearcase

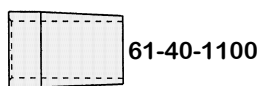

Refer to Product Support Bulletin # 281 for more information regarding seal guide 61-40-1100.

**Water Seal Jig - 61-30-0060** should be used when servicing shear pin model products (seal guide 61-30-1100 is not used when servicing shear pin models).