

COOLING SYSTEM & PLUGS



COOLER LINE PLUGS

Part No. 319

Plugs seal male or female fittings. Fit 1/4", 5/16", and 3/8" tubes. Allows vehicle to be driven from service bay with radiator off. Eliminates loss of transmission fluid and messy, slippery floors.



PLUG ALL STOPPERS

Part No. 312

Plugs fit 1/8", 3/16", 1/4", 5/16", 3/8" and 1/2" hoses. Tapered caps close tubes from 1/8" to 1/2". Use during tune-ups, vacuum tests and more.



PETCOCK SOCKET

Part No. 423

Fits petcocks used in radiators, engine blocks, etc. Can be used with 1/4" drive ratchet or 7/8" wrench. O-ring on socket helps hold wrench in place. Two slot design prevents damage to ears on petcock.

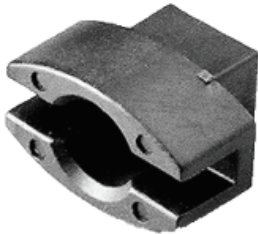

RADIATOR PETCOCK SOCKET

Part No. 473

1/4" drive socket is made for narrow-wing plastic drain plug fittings, both plug and flow-through types. Molded plastic socket prevents damaging soft plastic drain fittings. Socket resists automotive chemicals and fits most current vehicles.

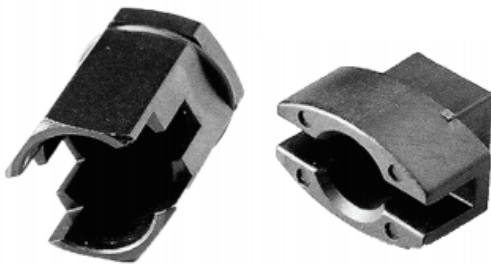

PETCOCK SOCKET SET

Part No. 485

1/4" drive set includes a steel universal socket to fit radiators, engine blocks, storage tanks, etc. with an O-ring to hold a 7/8" wrench in place. Set also has a molded plastic socket to fit narrow-wing plastic drain fittings, both plug and flow-through types.