

ASSEMBLAGE\_ASSEMBLY

increased hole diameter	12.04.18	VM
-	-	-
-	-	-
-	-	-

COLLÉ\_GLUED TOP  BASE  VELCRO  XTRA   
 ÉTIQUETTE\_LABEL STD  CLIENT  AUCUNE   
 SÉRIGRAPHIE\_SILKSCREEN PRINT  PLAIN   
 COULEUR\_COLOR : \_\_\_\_\_ KITS QT: \_\_\_\_\_

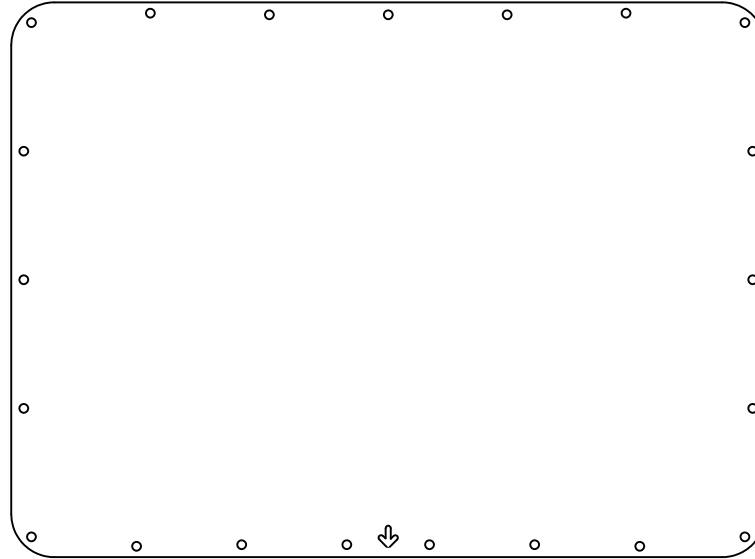

RECOMMENDED BEZEL PLATE THICKNESS

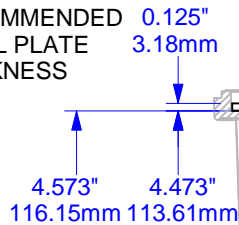

0.600" SCREW HOLE DEPTH  
 15.24mm

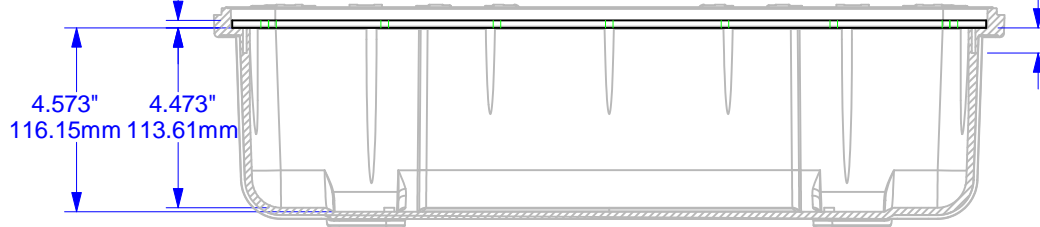

DEVIS\_LAYOUT

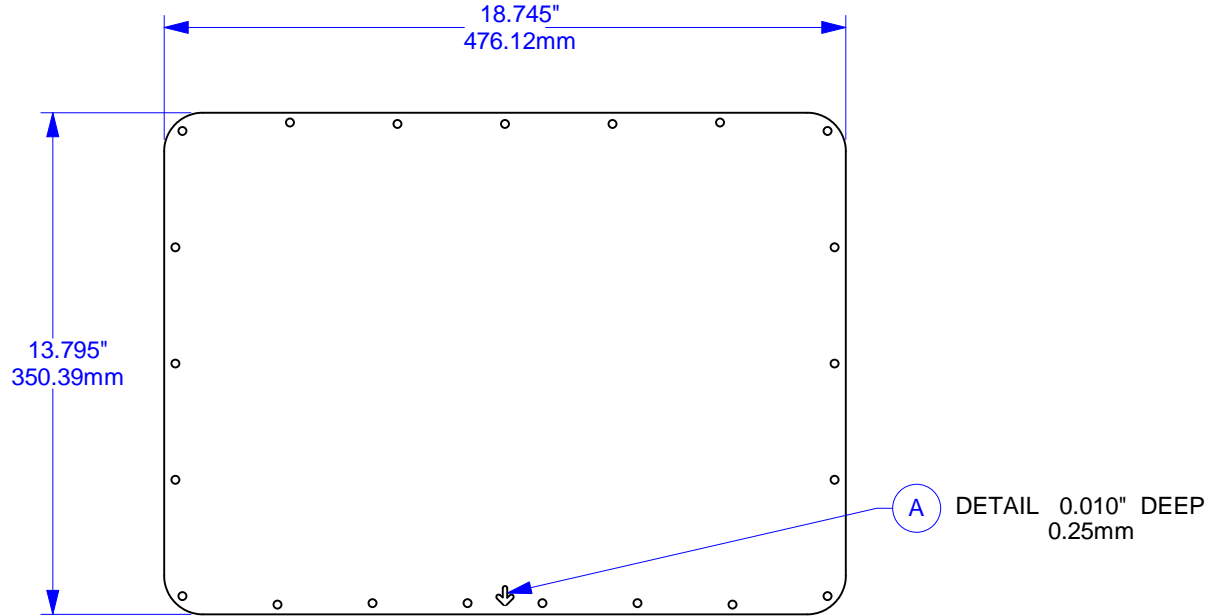

ALUMINIUM 1/8" THICK		
MATÉRIEL_MATERIAL		
-	77"	1
DETAILS	PC LINÉAIRE_LINEAR IN	QTÉ_QTY

DIMENSIONS EN POUCE SAUF SI INDIQUÉ, UNLESS OTHERWISE SPECIFIED DIMENSIONS ARE IN INCHES  
 LA DENSITÉ DU MATÉRIEL PEUT VARIER, FOAM DENSITY MAY VARY TOLERANCE +/- 1/16"

DÉTAILS\_DETAILS

R 1.068" TYP  
 27.13mm

Ø 0.219" TYP  
 5.56mm

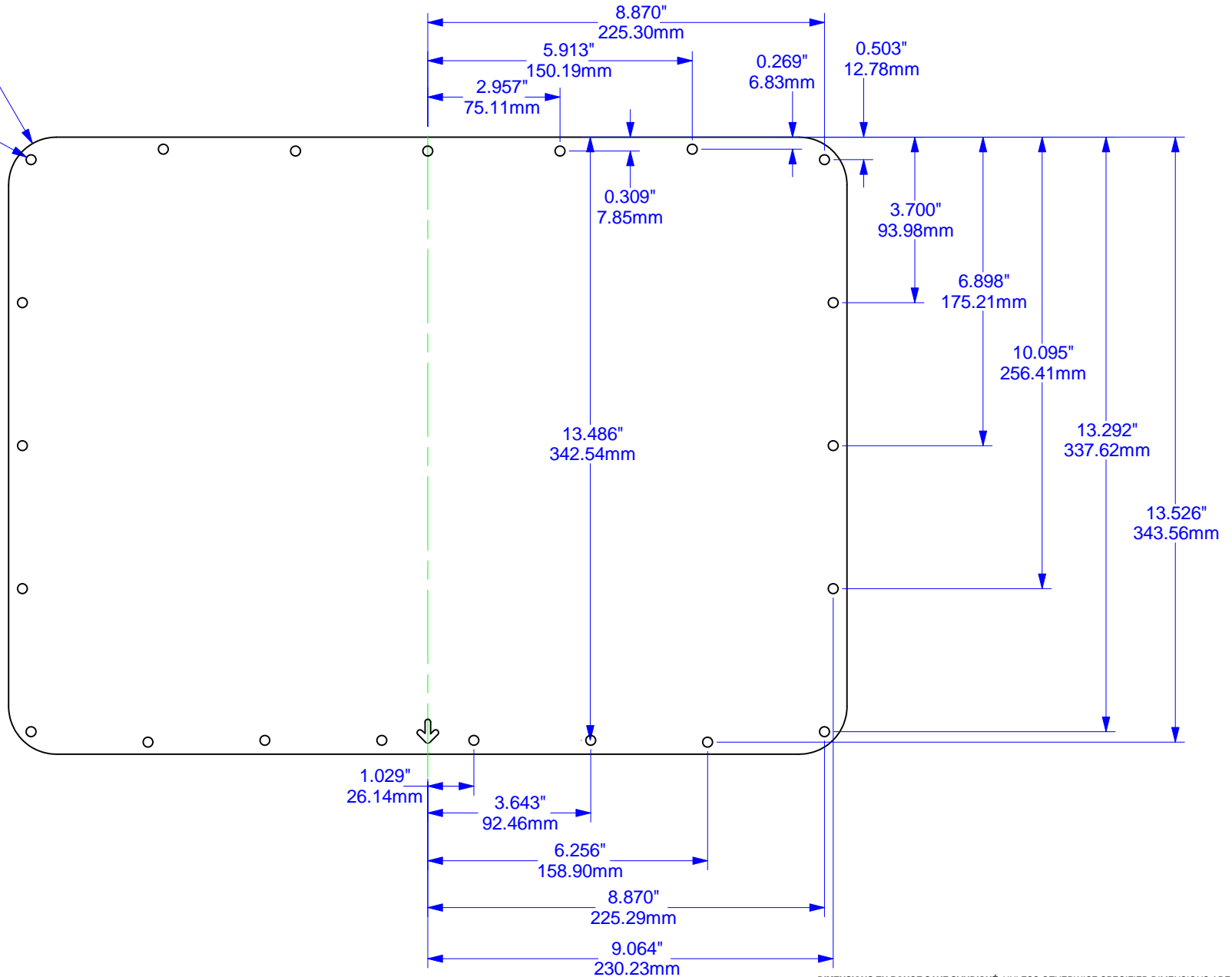

DIMENSIONS EN POUCE SAUF SI INDIQUÉ, UNLESS OTHERWISE SPECIFIED DIMENSIONS ARE IN INCHES  
 LA DENSITÉ DU MATÉRIEL PEUT VARIER, FOAM DENSITY MAY VARY TOLERANCE +/- 1/16"