



# ASSEMBLY INSTRUCTION

## speakON STX Series | Lockable Loudspeaker Connector

### 4 pole Cable Connector with metal housing

#### IMPORTANT SAFETY INSTRUCTION

Electrical Rating acc. UL & CSA:  
 USR: 40A/250V, CNR: 25A/250V

“CAUTION: NOT FOR INTERRUPTING CURRENT”  
 “ATTENTION: NE PAS UTILISER POUR COUPER LE COURANT”

#### Assembly of the Cable Connector:

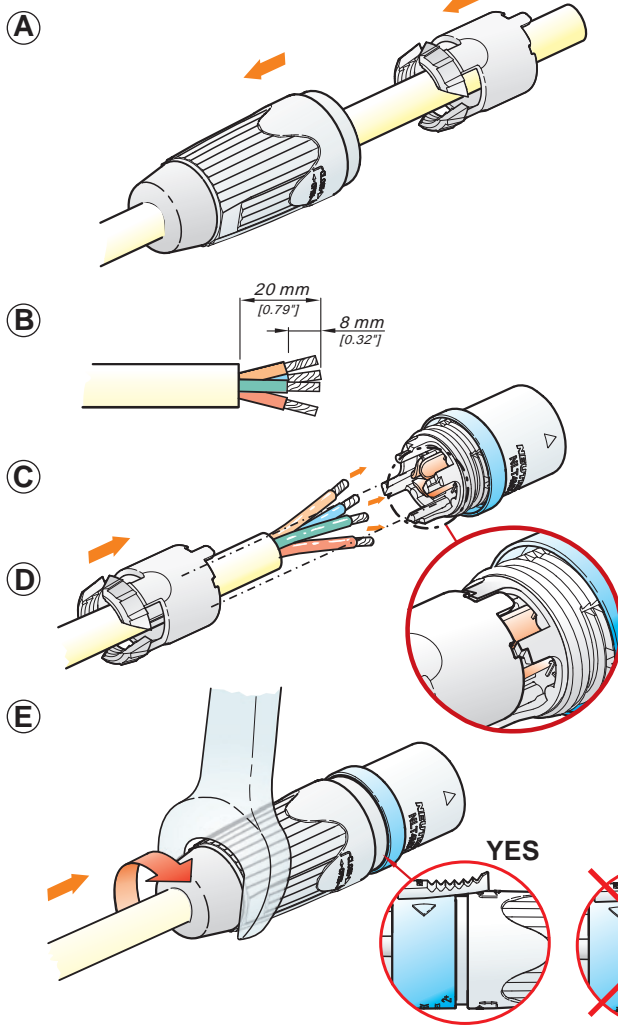

- A** Place bushing and chuck over the cable.
- B** Prepare cable as shown.
- C** Solder the wire ends to contacts of insert.
- D** Slide the chuck up the cable and align with the housing.  
**Important:** Align the chuck by positioning the nose into the smaller recess.
- E** Slide the bushing up the cable and tighten it (flat wrench SW 22mm).  
**Important:** Bushing must be screwed onto housing minimum 3 turns thus there is no gap between housing and bushing.

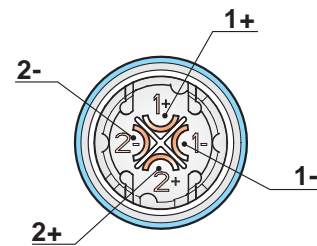

#### Wiring of the Receptacle and the Female Cable Connector:

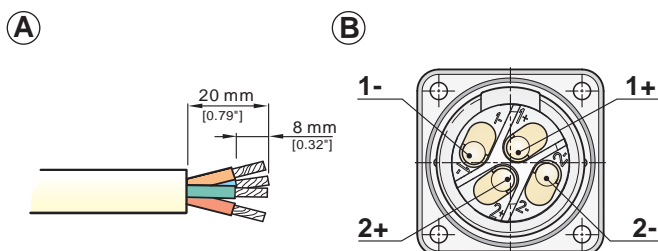

- A** Prepare cable as shown.
- B** Insert the wires into the terminals and solder it.

NEUTRIK AG LI T: +423 / 237 24 24 F: +423 / 232 53 93  
 NEUTRIK USA Inc. USA T: +1 732 / 901 9488 F: +1 732 / 901 9608  
 NEUTRIK (UK) Ltd. UK T: +44 1983 / 811 441 F: +44 1983 / 811 439  
 NEUTRIK Vertriebs GmbH DE/NL/AT/DK T: +49 8131 / 280 890 F: +49 8131 / 280 830

NEUTRIK France FR T: +33 1 / 4131 6750 F: +33 1 / 4131 0511  
 NEUTRIK Tokyo Ltd. JP T: +81 3 / 3663 4733 F: +81 3 / 3663 4796  
 NEUTRIK Hong Kong Ltd. HK T: +852 / 2687 6055 F: +852 / 2687 6052

Draft. Nr.: BDA 118 / 3102M1181 | Update: 29.09.2009 | Data subject to change without prior notice. ©2009 NEUTRIK®. ALL RIGHTS RESERVED.