

Certified "Best Value" Performance by B-I-C America



DV32 Mini Speakers

Design:

Two-way mini speaker system

Driver Complement:

3.5" poly/graphite woofer,
1/2" poly dome tweeter

Frequency Response: 80Hz - 20kHz

Sensitivity: 90dB @ 1 watt, 1 meter

Power Handling:

5 - 125 watts per channel

Impedance: 8 ohms

Finish: Black

Gold Plated Terminals: YES

Dimensions: 7" H x 4 7/8" W x 4 1/8" D

Weight: 7 lbs. per pair

Warranty: 7 years parts

Easy to Mount

Mounting flat on a wall

Use this screw
mount position

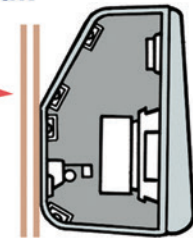

SIDE VIEW

Mounting high on
the wall with
speaker pointing
down toward
listening position

SIDE VIEW

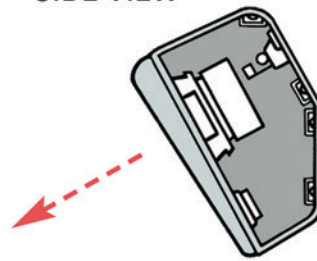

Use these two
screw mounting
positions

Use template to locate these two screw mounting
positions

TOP VIEW

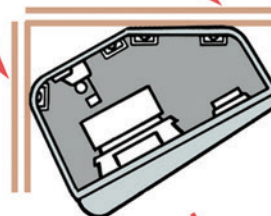

Corner
mounting
with
speaker
pointing
toward
listening
positions

B-I-C AmericaTM

Top-Rated Loudspeakers Since 1973

925 N. Shepard Street • Anaheim, CA 92806

www.bicamerica.com

Designed and Engineered in the U.S.A.
Manufactured in China