

SPT[®]

SF-1536W

36 inch Tower Fan

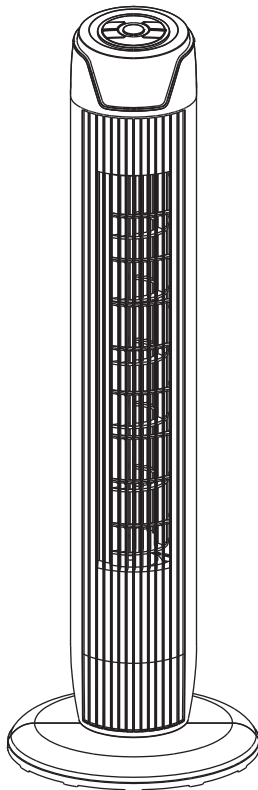

READ AND SAVE THESE INSTRUCTIONS

Attention: Pictures are for reference only and may not be exact

IMPORTANT SAFETY INSTRUCTIONS

CAUTION

Read Completely for Safe Operation and Operating Instructions Before Using.

1. Do not leave the fan running unattended.
2. Keep electrical appliances out of reach from Children or infirm persons. Do not let them use the appliances without supervision.
3. This appliance has a polarized plug (one blade is wider than the other). To reduce the risk of electric shock, this plug is intended to fit in a polarized outlet only one way. If the plug does not fit fully in the outlet, reverse the plug. If it still does not fit, contact a qualified electrician. Do not attempt to bypass this safety feature.
4. If the power cord is damaged, it must be replaced by manufacturer or its Service agent or a similarly qualified person in order to avoid a hazard.
5. This appliance is not intended for use by persons (including children) with reduced physical, sensory or mental capabilities, or lack of experience and knowledge, unless they have been given supervision or instruction concerning use of the appliance by a person responsible for their safety. Young children should be supervised to ensure that they do not play with the appliance.
6. Do not attempt to disassemble the appliance! The rotor blade guard shall not be taken off.
 - Prior to cleaning, unplug the fan from the outlet.
 - The rotor guard shall not be dissembled/opened to clean the rotor blades.
 - If necessary, use a vacuum or compressor air to remove large dust particles
 - Wipe the fan enclosure and rotor blade guard with a slightly damp cloth.
 - Do not spray water or any other cleaner directly onto the unit.
7. **WARNING**—To reduce the risk of fire or electric shock, Do not use this fan with any solid-state speed control device.
8. This product employs overload protection (fuse). A blown fuse indicates an overload or short-circuit situation. If the fuse blows, unplug the product from the outlet. Replace the fuse as per the user servicing instructions (follow product marking for proper fuse rating) and check the product. If the replacement fuse blows, a short-circuit may be present and the product should be discarded or returned to an authorized service facility for examination and/or repair.

PART FIGURE

1. Body
2. Rear base
3. Front base
4. Plastic nut
5. Power cord

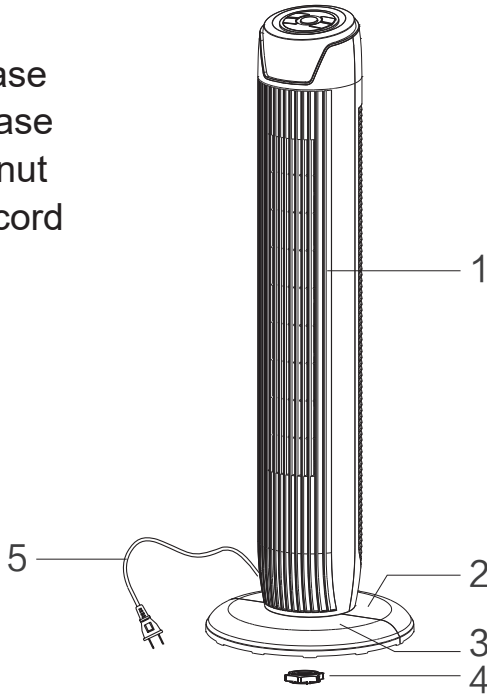

Note: All the pictures in this manual are for explanation purpose only. Any discrepancy between the real object and the illustration in the drawing shall be subject to the real subject.

ASSEMBLY INSTRUCTIONS

1. Take out the fan body and the spare parts from the box. Put the front base onto rear base and join them together. (See Fig. 1)
2. Unlock the plastic nut from the fan body.
3. Pass the power cord through the flute, then insert the fan body into the base. (See Fig. 3)
4. Fix the fan body on the base with the plastic nut. (See Fig. 2)

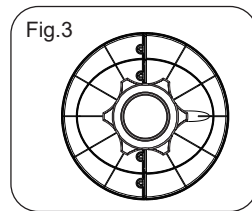
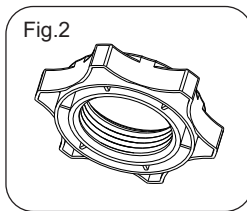
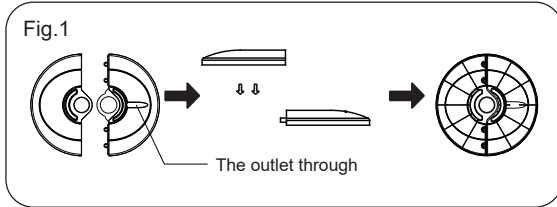

OPERATION INSTRUCTION

I. Remote Controller (Fig.4)

a. KEY INSTRUCTION

1. "⏻" ON/OFF KEY

The "ON" key is for switching on the fan. The fan will be started at breeze step.

Press the "OFF" key if the fan needs to switch off.

2. "⊗" SPEED KEY

When the fan started, press this key repeated, the fan will work with "1-2-3" circulatory.

3. "⊙" MODE KEY

Press this key to select mode. The sequence is normal, natural, and sleep when this key being touched repeatedly or continuously. The light indicate mode state.

4. "↺" OSC/LOUVER KEY

After the fan has started, press this key to select oscillation mode. The lights on the display can indicate fan oscillation mode.

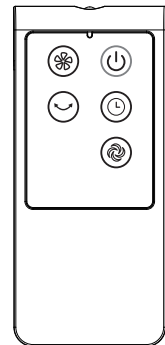

Fig.4

5. "⌚" TIMING KEY

Press this timer key repeatedly to set the time for air delivery. Increase in increments up to "1-2-3-4-5-6-7" hours.

b. BATTERIES

(battery not included in the packaging)

- (1) Slide the battery compartment Cover.
- (2) Insert the batteries, and make sure that the batteries are placed as shown in the Fig.5.
- (3) Slide back the battery cover.

NOTES: Use manganese or alkaline batteries of type "AAA". Do not use rechargeable batteries.

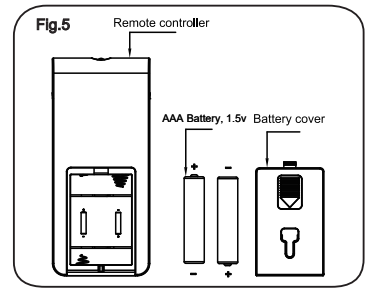

c. BATTERY WARNING AS BELOW

1. "Do not dispose of batteries in fire, batteries may explode or leak."
2. -Do not mix old and new batteries.
3. -Do not mix alkaline, standard (carbon-zinc) or rechargeable (nickel-cadmium) batteries.

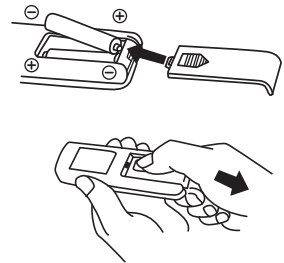

d. REMOTE CONTROLLER OPERATION

Point the remote controller at the receptor on body of the fan and press the desired button. The remote controller will work at distances of up to roughly five meters and the angle of 30 degree included between right and left from the receptor.

The batteries must be removed from the remote controller before it is scrapped and that they are disposed of safely.

e. OVERHEAT PROTECTION OF THE MOTOR

The windings of the motor have a thermal-fuse that burns out and the fan switches off and temperature of the motor is no longer going up so that plastic parts of the fan don't subject to deformation so far so to be burned by the overheat if the motor is overheat for any unexpected reason.

II. Buttons on fan body / Panel indication (Fig.6)

The buttons on the body such as ON/OFF, SPEED, MODE, TIMER, OSCILLATION have the same functions as those of the corresponding keys on the remote controller.

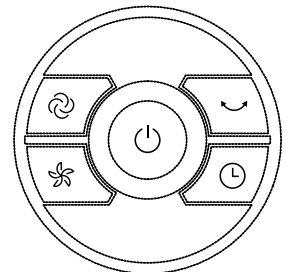
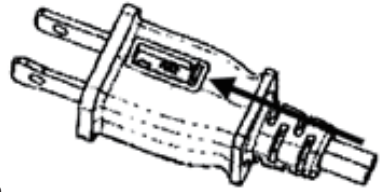

Fig.6

USER SERVICING INSTRUCTIONS

- a) Grasp plug and remove from the receptacle or other outlet device. Do not unplug by pulling on cord.
- b) Open fuse cover. Slide open fuse access cover on top of attachment plug towards blades.
- c) Remove fuse carefully. Insert the tip of your tool into fuse slot (close with the terminal), then prize the fuse gradually and slowly, but not overexert. If you feel tight, you can try it at several times and prize the fuse little by little. When one side of the fuse has been prized, then you can get the fuse out entirely.
- d) Risk of fire. Replace fuse only with 2.5 Amp, 125 Volt fuse.
- e) Close fuse cover. Slide closed the fuse access cover on top of attachment plug.
- f) Risk of fire. Do not replace attachment plug. Contains a safety device (fuse) that should not be removed. Discard product if the attachment plug is damaged.



Notice:

1. When you replace the fuse, please don't operate suddenly or overexert, or else the product will be damage or cause accident.
2. When you feel it hard to be operated, please make sure you have got the right way.

CLEANING

1. Be sure to unplug from the electrical supply source before cleaning.
2. Plastic parts should be cleaned with mild soap and a damp cloth or sponge. Thoroughly will remove soap film with clean water.
3. Be sure not to make water or other liquid enter inside of motor.

Your Guarantee

If this product is found to be faulty as a result of faulty materials or workmanship within one year from date of purchase, it will be repaired free of charge.

This guarantee is subject to the following terms:

- Sunpentown must be notified of the fault.
- Proof of purchase must be presented to Sunpentown's nominated representative.
- The warranty will be void if the product is modified, misused or repaired by an unauthorized person.
- The warranty after repair will not be extended beyond the original one-year period.
- All replacement parts will be new or reconditioned.
- Parts, which are replaced, become the property of Sunpentown.
- The warranty applies for the use of the product in the USA only.

What is NOT COVERED:

- Warranty does not include freight charges.
- Damage due to installation error, product abuse and/or misuse.
- Incidental or consequential damage caused by possible defects with this product.
- Labor cost incurred for the installation and/or removal of a possible defective unit.
- Damage to product caused by improper power supply voltage, accident, fire, floods or acts of nature.
- Failure of product resulting from unauthorized modifications to the product.
- Improper installation or failure to perform the necessary maintenance.
- Normal wear and tear on parts or replacement of parts designed to be replaced.
- Damage to personal property from use of product.
- Replacement or repair of household fuses, circuit breakers, wiring or plumbing.

This GUARANTEE is in addition to your Statutory Rights

SUNPENTOWN INTERNATIONAL INC.
14625 Clark Ave. City of Industry, CA 91745
Tel: 800-330-0388
service@sunpentown.com
www.sunpentown.com