

Section 1: Parts and Assembly

WARNING: DO NOT assemble the fan with while the fan is plugged into an outlet.

Base/shaft assembly:

Step 1: Remove the nut from the bottom of the adjustable shaft by turning counter-clockwise.

Step 2: Insert the shaft into the base from the top. When positioned correctly shaft will lock into the base.

Step 3: Lock the fan shaft to the base by reapplying the nut. Turn clockwise to tighten.

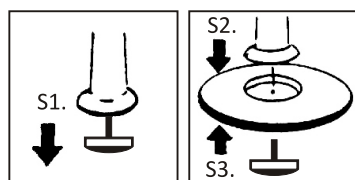

Fan assembly

1. Base/shaft assembly (see picture)
2. Insert shaft into base
3. Insert main motor into adjustable height main shaft.
(ABS height adjustable shaft 7.8")
4. Rear Grill
5. Nut – turn to tighten
6. Fan Blade
7. Fan blade cap – turn counter clockwise to tighten
8. Front Grill
9. Fan grill security latch – (see picture below)

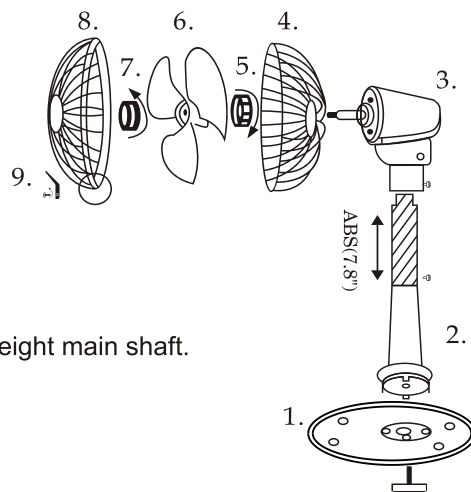

Section 2: Fan Grill Security Latch

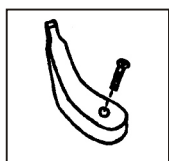

1. Follow the picture and remove the screw of the security latch by turning it counter clockwise. Located on the bottom of the fan grill, thread the security latch so it secures the junction of the front and back fan grill, use the screw to tightened the latch into place. When placed properly, the security latch should prevent the front and back grill from separating.

Section 3: Using your fan

Warning: Please ensure the plug is properly plugged into a 120V outlet ONLY.

1. Fan speed control is as follows:

- " 0 " – OFF
- " 1 " – Low strength
- " 2 " – Medium strength
- " 3 " – High strength

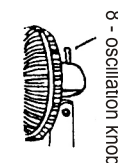

2. 8 - oscillation knob

- When 8 - oscillation is desired, press down gently on the oscillation knob into the down position.
- When oscillation is not needed, pull up gently on the oscillation knob into the up position.

Section 4: General Safety Warnings

1. Please ensure the outlet is an approved 120V outlet.
2. This unit should only be operated by persons with proper safety knowledge of this fan. NOT meant to be operated by kids, or people with conditions that may affect the proper use of this fan.
3. This fan is NOT a toy. Please keep out of the reach of children.
4. Not meant to be used 2000M above sea level.
5. Please only operate the fan on smooth and even surfaces to avoid the potential of toppling over causing injury.
6. When the fan is oscillating, DO NOT exert manual force to stop the oscillation. (follow proper oscillation knob control instructions)
7. When the fan is operating, DO NOT stick fingers or any foreign objects inside the fan grill.
8. DO NOT place this fan near source of heat or water. No operating in bathrooms.
9. DO NOT bend the power cord excessively or at odd angles to avoid damage which may cause a short circuit.
10. DO NOT let the unit topple or bang against hard surfaces to avoid damage.
11. When the fan is not in use, please unplug the fan from the outlet and store properly.

Section 5: Cleaning and maintenance

WARNING: To avoid serious injury from electric shock, the unit must be turned OFF and unplugged prior to any cleaning or maintenance. When disconnecting the power cord, grip and pull the plug from the electrical plug, do not grip and pull from the power cord.

- 1.DO NOT use any harsh cleaning agents to avoid causing discoloration or damaging the unit.
- 2.DO NOT spray the unit directly with water to clean. This may cause water to get inside the motor and cause electrical shock or short circuit.
- 3.To clean the front/back grill and fan blades, disassemble from main motor unit. Clean thoroughly with water/gentle soap, WIPE the grill and fan blades DRY COMPLETELY before reassembling to the motor unit.
- 4.To clean the outer surfaces of the unit, dampen a towel with gentle soap/water and wipe thoroughly. Please DRY ALL SURFACES of the unit completely before operating.
- 5.The motor unit can be lubed on occasion to prolong its lifespan.

Section 6: Malfunction

1. If the fan is malfunctioning and could potentially cause harm, please unplug the unit from the outlet and contact the manufacturer immediately for assistance.

Equipment name : stand fan › Type designation : SF-16S88						
Unit	Restricted substances and its chemical symbols					
	Lead (Pb)	Mercury (Hg)	Cadmium (Cd)	Hexavalent chromium (Cr ⁺⁶)	Polybrominated biphenyls (PBB)	Polybrominated diphenyl ethers (PBDE)
Fan motor	○	○	○	○	○	○
Switch group	○	○	○	○	○	○
Capacitor	○	○	○	○	○	○
Power cord set	○	○	○	○	○	○
Metallic parts	○	○	○	○	○	○
Plastic parts	○	○	○	○	○	○
Note 1: “○” indicates that the percentage content of the restricted substance does not exceed the percentage of reference value of presence.						
Note 2: The “-” indicates that the restricted substance corresponds to the exemption.						



Your Guarantee

If this product is found to be faulty as a result of faulty materials or workmanship within one year from date of purchase, it will be repaired free of charge.

This guarantee is subject to the following terms:

- Sunpentown must be notified of the fault.
- Proof of purchase must be presented to Sunpentown's nominated representative.
- The warranty will be void if the product is modified, misused or repaired by an unauthorized person.
- The warranty after repair will not be extended beyond the original one-year period.
- All replacement parts will be new or reconditioned.
- Parts, which are replaced, become the property of Sunpentown.
- The warranty applies for the use of the product in the USA only.

What is NOT COVERED:

- Warranty does not include freight charges.
- Incidental or consequential damage caused by possible defects with this product.
- Damage to product caused by improper power supply voltage, accident, fire, floods or acts of nature.
- Failure of product resulting from unauthorized modifications to the product.
- Improper installation or failure to perform the necessary maintenance.

This GUARANTEE is in addition to your Statutory Rights

SUNPENTOWN INTERNATIONAL INC.
 14625 Clark Ave, City of Industry, CA 1745
 Tel: 800-330-0388 • Fax: 626-336-7116
service@sunpentown.com
www.sunpentown.com