

# UXP-4MT-14S

## 4.3-10 Male Torque Connector for 1/4" Superflexible Cable

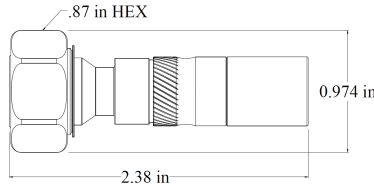

[Installation video](#)

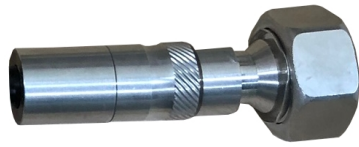

[Installation instructions](#)



Contact technical support:

1-888-201-6073

[techsupport@jmawireless.com](mailto:techsupport@jmawireless.com)

General	Specification
<b>Interface/gender</b>	4.3-10 Male, torque type
<b>Cables supported<sup>1</sup></b>	Andrew FSJ1-50A, FSJ1RK-50B, PTS1-50-P; RFS SCF 14-50J, SCF 14-50JFN; Hansen RF5014S, RF5014SZ; Eupen EC1- 50-HF; Times SPP-250-LLPL, HUBER+SUHNER SUCOFEEED 1/4 HFFR, HUBER+SUHNER SUCOFEEED 1/4 HF, Times SPO-250
<b>Weight</b>	0.220 lbs.   100 g
<b>JMA Weather Protection System</b>	WPS-N-1S

Tools required	JMA part number	Comment
<b>Cable preparation</b>	SP-14S	No coring required
<b>Connector compression</b>	HCG-FRAMESET-14B, HCG-CC	
<b>Torque wrench</b>	TQ-78-F8	8 lbf·ft   10.85 N·m

Frequency band	VSWR	Return loss (dB)
<b>555–1000 MHz (0-1 GHz)</b>	1.02	40
<b>1000–2700 MHz (1-2 GHz)</b>	1.03	38
<b>2700–3800 MHz (2-4 GHz)</b>	1.05	30
<b>3800–6000 MHz (4-6 GHz)</b>	1.08	26

Electrical	Specification	Comment
<b>Connector impedance</b>	50 ohm	
<b>Operating frequency band</b>	DC–6 GHz	
<b>3rd order IMD dynamic, (PIM)</b>	-161 dBc, typical	IEC 60237-02, -3
<b>DC test voltage</b>	1600 V	
<b>Center contact resistance</b>	≤ 0.8 milliohm	
<b>Outer contact continuity</b>	1.0 milliohm max.	
<b>Average power</b>	600 W @ 900 MHz	
<b>Peak power, max.</b>	15 kW	
<b>Insertion loss, typical</b>	0.05 dB	Per connector
<b>Shielding effectiveness</b>	< -120 dB	@ 0-1 GHz

Mechanical	Specification	Comment
<b>Pull force combined</b>	.67 kN   >150 lb	Cable limited
<b>Cable retention torque</b>	2 N·m   1.5 lbf·ft	Cable limited
<b>Interface durability</b>	100 cycles	IEC 61169-4:9.5

Environmental	Specification	Test
<b>Operating temperature</b>	-55 °C to +85 °C (-67 °F to 185 °F)	
<b>Storage temperature</b>	-55 °C to +85 °C (-67 °F to 185 °F)	
<b>Accelerated UV</b>	1000 hr	ASTM G154
<b>Immersion test method</b>	Mated & unmated, IP68	IEC 60529:2001 & ANSI/SCTE 60
<b>Water jetting test method</b>	Mated & unmated, IP66	IEC 60529:2001
<b>Mechanical shock test method</b>	Pass	IEC 60068-2-27
<b>Thermal shock test method</b>	Pass	IEC 60068-2-14
<b>Vibration test method</b>	100 m/s <sup>2</sup> , 2 Hz to 200 Hz	IEC 61169-1:2003
<b>Corrosion test method</b>	1000 hr	IEC 60068-2-11

<sup>1</sup>For cable types not listed, please contact JMA Technical Support.