

Installation Guide

KM 402 Kit Air/Mech Installation (PN: 6791 & 6792)

1. Remove original seat and suspension from the cab.
2. Install the Seat Well Extension Kit (S.W.E.K) PN 6052.
3. Cut 4 1/2" of the cab metal from the left side of the seat well cavity. (Use of a reciprocating saw (eg. Sawzall) is recommended.)
4. Place the S.W.E.K. into the opening from the bottom side of the cab and fasten with sheet metal screws provided. Use a 5/32" drill bit for the holes.
5. Caulking can be used to seal around the edges of the S.W.E.K. if desired.

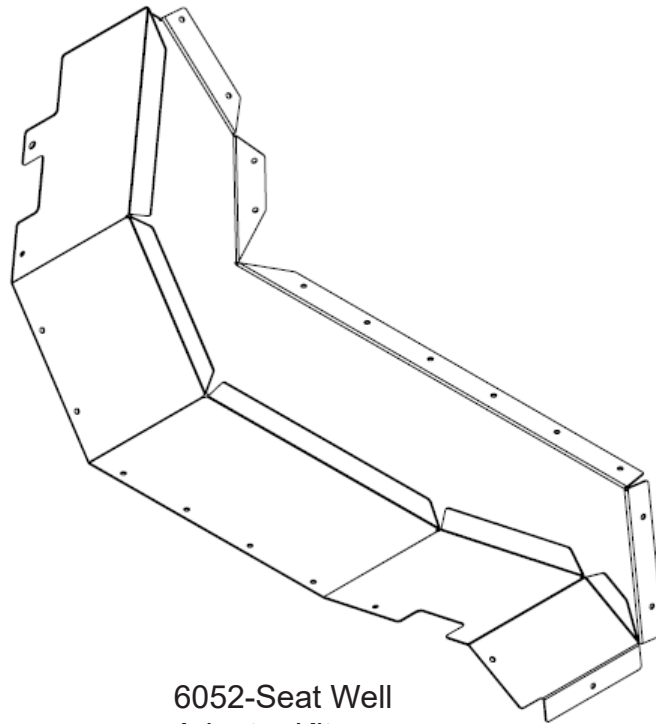

6052-Seat Well
Adapter Kit

Installation Guide

KM 402 Kit Air/Mech Installation (PN: 6791 & 6792)

- Determine if your seat well has an angled front section or a square front section. For models with the angled front section, use the JD W43A plate. For models with the square front section, use the JD W43B plate.
- Bolt W43A or W43B plate to the bottom of the PED JD 43 with two 5/16" x 3/4" carriage bolts and flange nuts.
- Place the PED W43 into the seat well in the location it will be fastened. It may help to bolt the JD W43 Plate to the back of the cab using the original bolts to secure it. Check to make sure the W43A or W43B plate, which ever is installed, is tight to the front section of the seat well. Loosen the bolts and adjust if necessary.
- With the PED W43 assembly in place in the seat well mark the location of the front holes onto the seat well.
- Remove the PED W43 assembly from the cab and drill two 11/32" holes through the seat well where you marked.

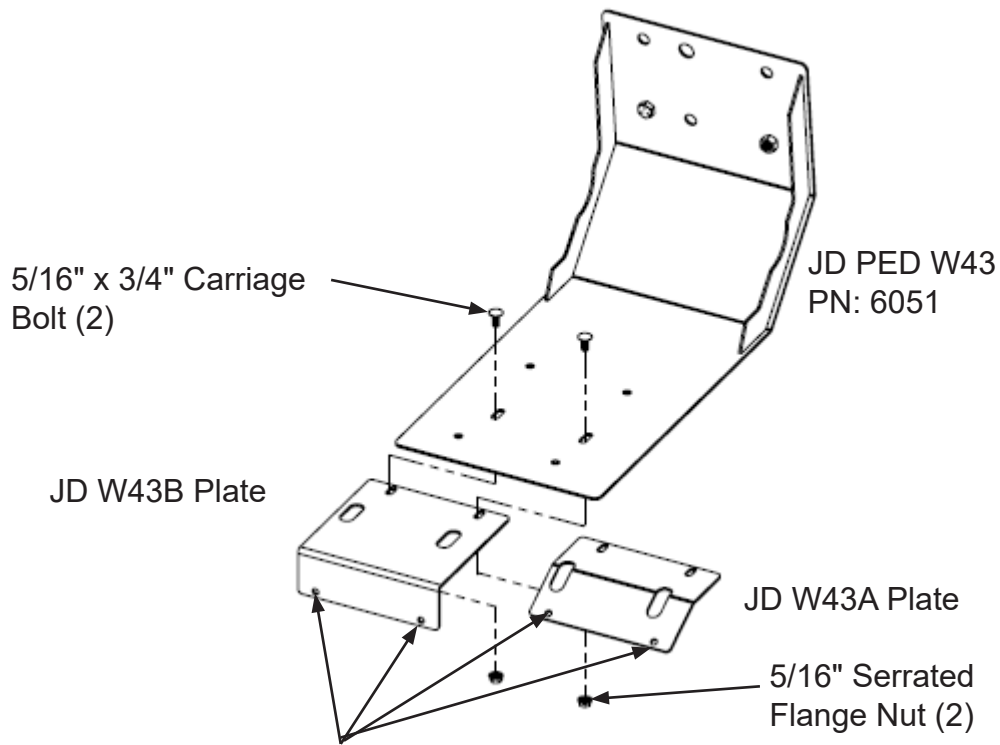

Use these holes to mark locations on the seat well to drill.

Installation Guide

KM 402 Kit Air/Mech Installation (PN: 6791 & 6792)

11. Bolt the slide rails to the suspension using four 8mm x 12mm low profile socket cap screws. The slide rail must be assembled with the adjustment lever to the left side of the seat and suspension.

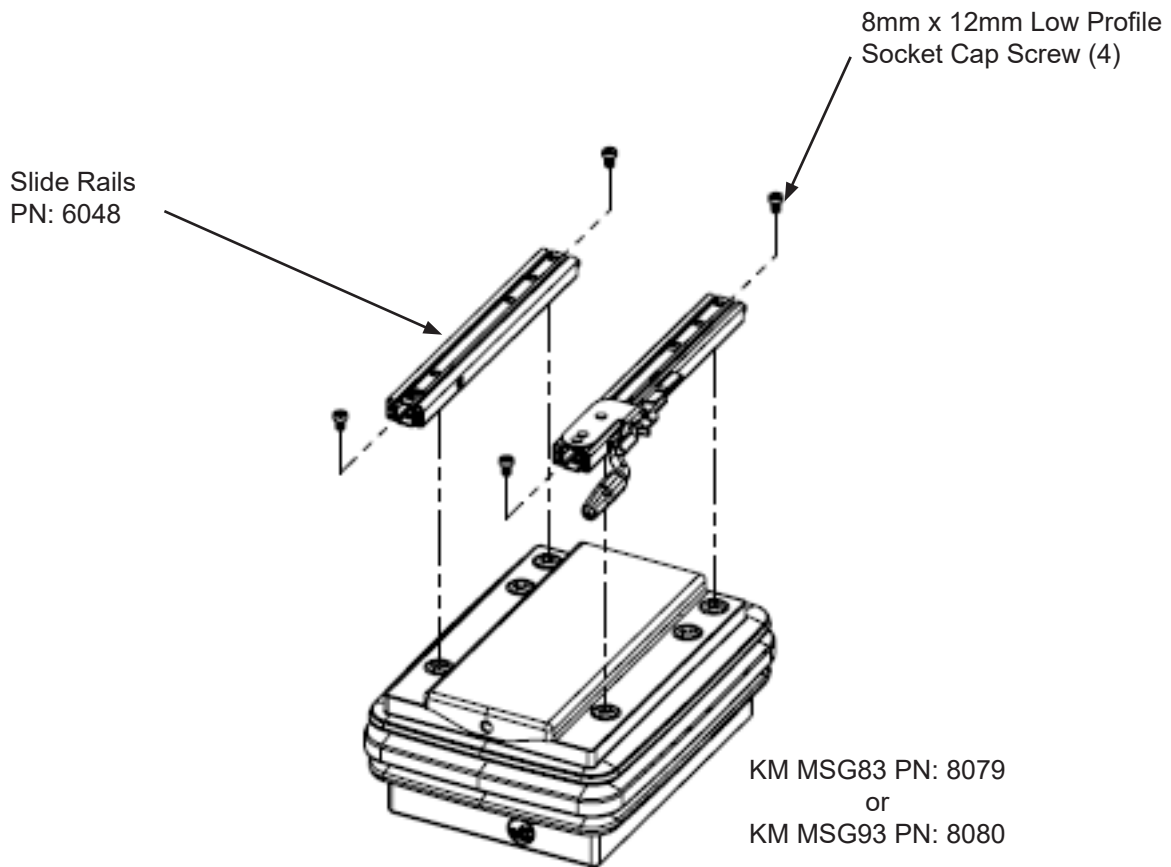

Installation Guide

KM 402 Kit Air/Mech Installation (PN: 6791 & 6792)

12. Bolt the 6080 SAP to the slide rails using four 5/16" x 3/4" flat head socket cap screws, three flat washers, and four 5/16" jam nuts. The three flat washers go in between the 6080 SAP and the slide rails as shown below.

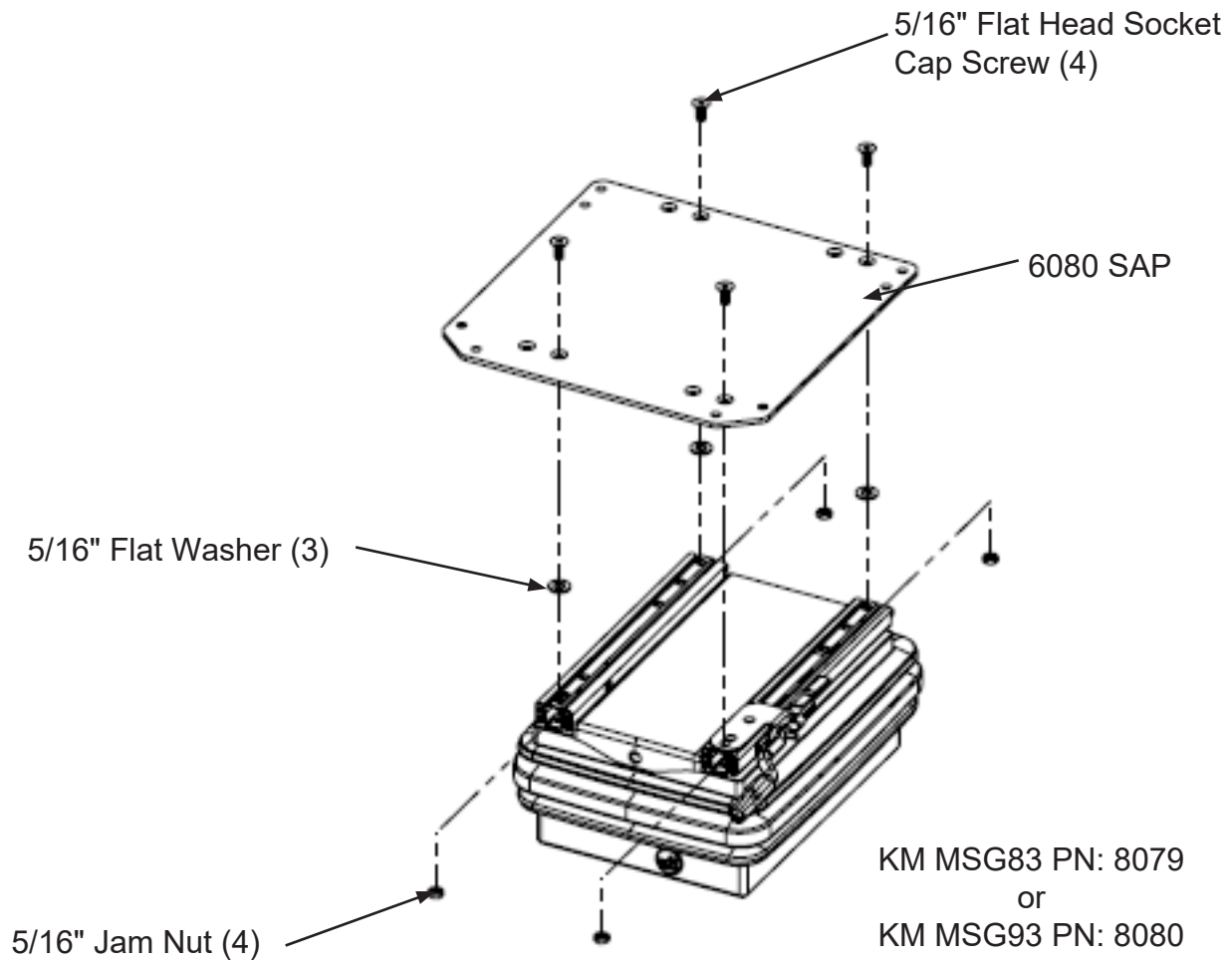

Installation Guide

KM 402 Kit Air/Mech Installation (PN: 6791 & 6792)

13. Bolt the suspension to the JD PED W43 using four 5/16" x 3/4" bolts, lock nuts, and .225" spacers. The spacers install between the suspension and the JD PED W43. You need to loosen the lower part of the rubber bellows to access the inside of the suspension to install the nuts onto the bolts.

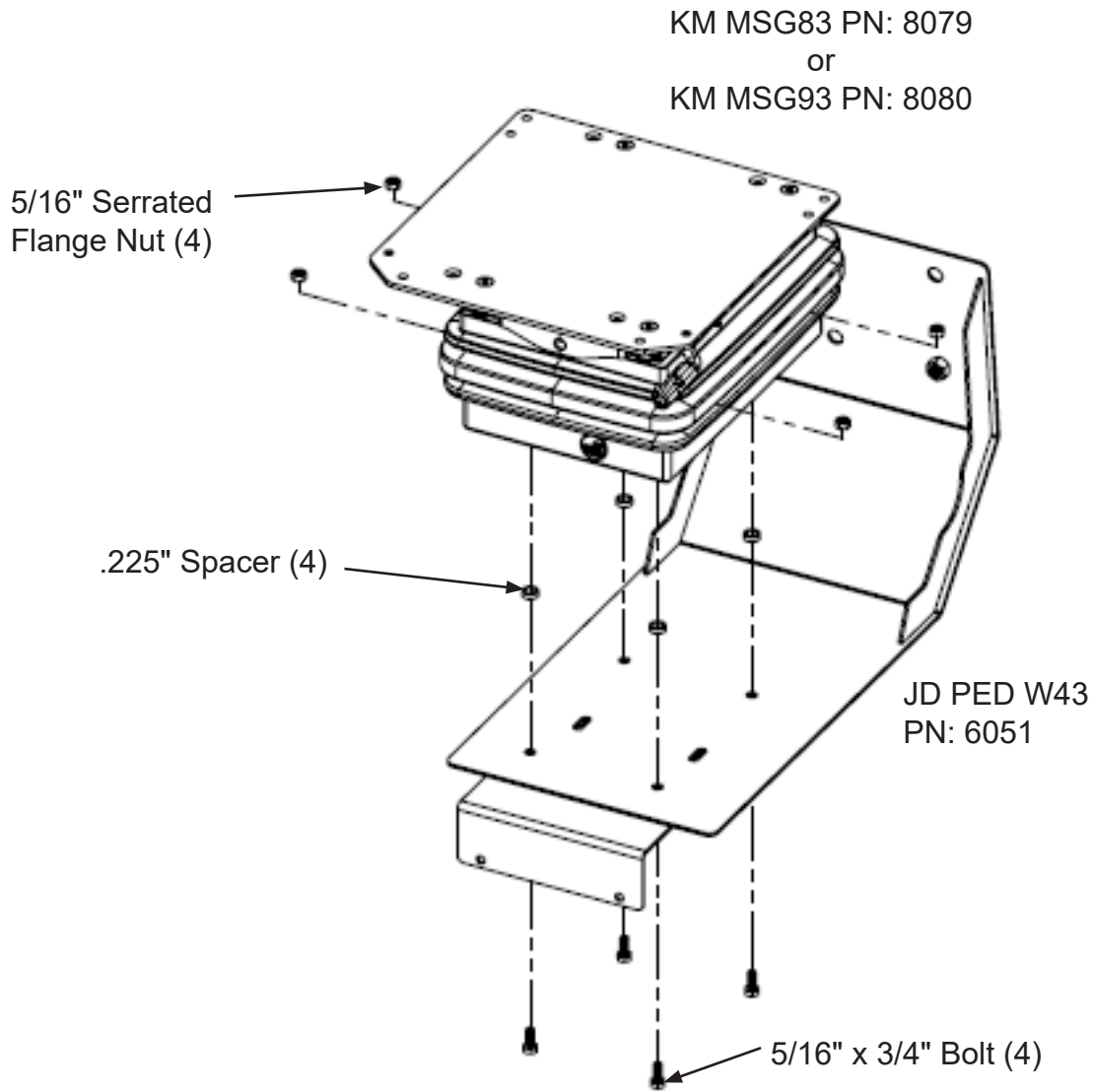

Installation Guide

KM 402 Kit Air/Mech Installation (PN: 6791 & 6792)

14. Mount the JD PED W43 and suspension assembly to the back of the cab using the original bolts.
15. Fasten the W43A or W43B plate, whichever is installed, to the cab deck where the holes were drilled in step 10. Use two 5/16" x 3/4" and 5/16" serrated flange nuts for fasteners.

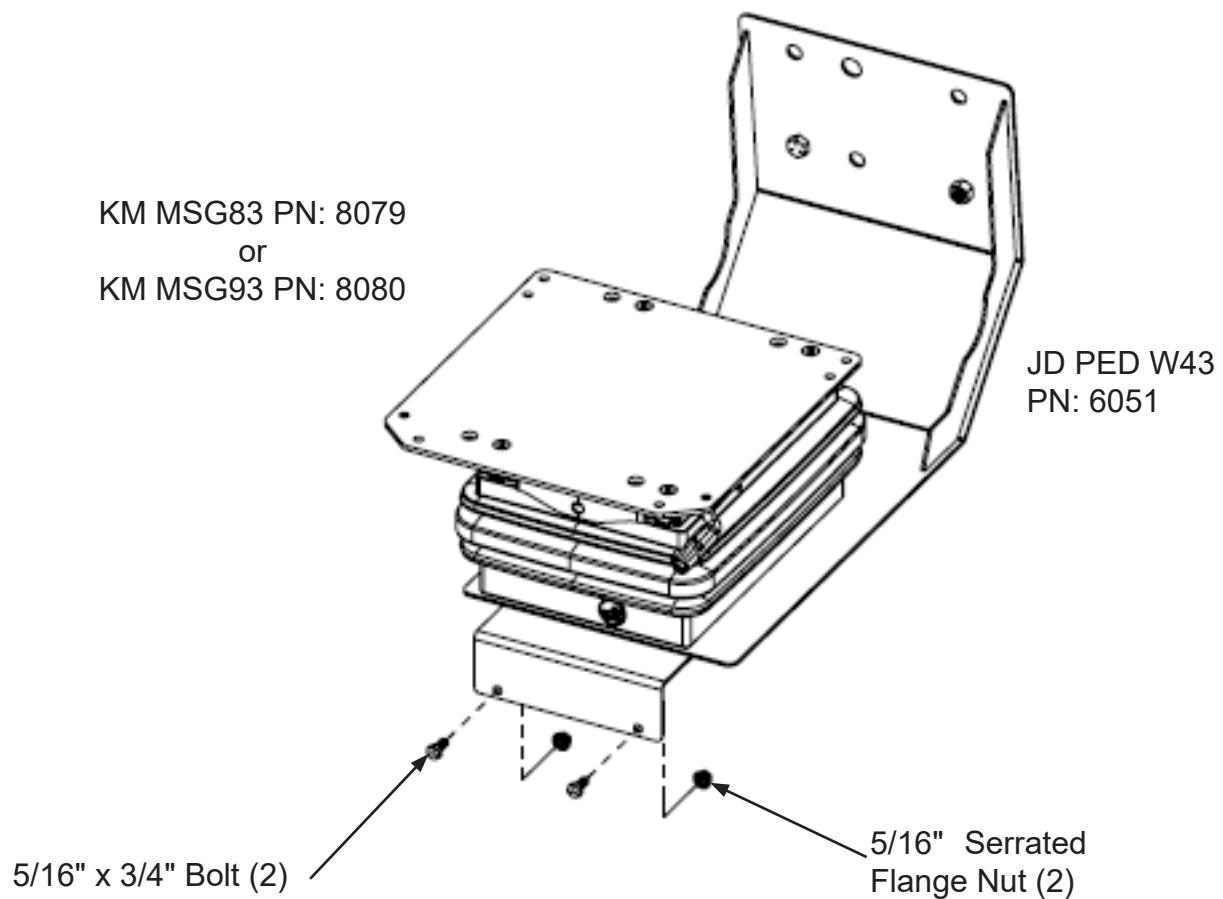

Installation Guide

KM 402 Kit Air/Mech Installation (PN: 6791 & 6792)

16. If a swivel was purchased, remove the plastic knock outs from the locations shown below. If no swivel was purchased, continue to step 24 on page 10.

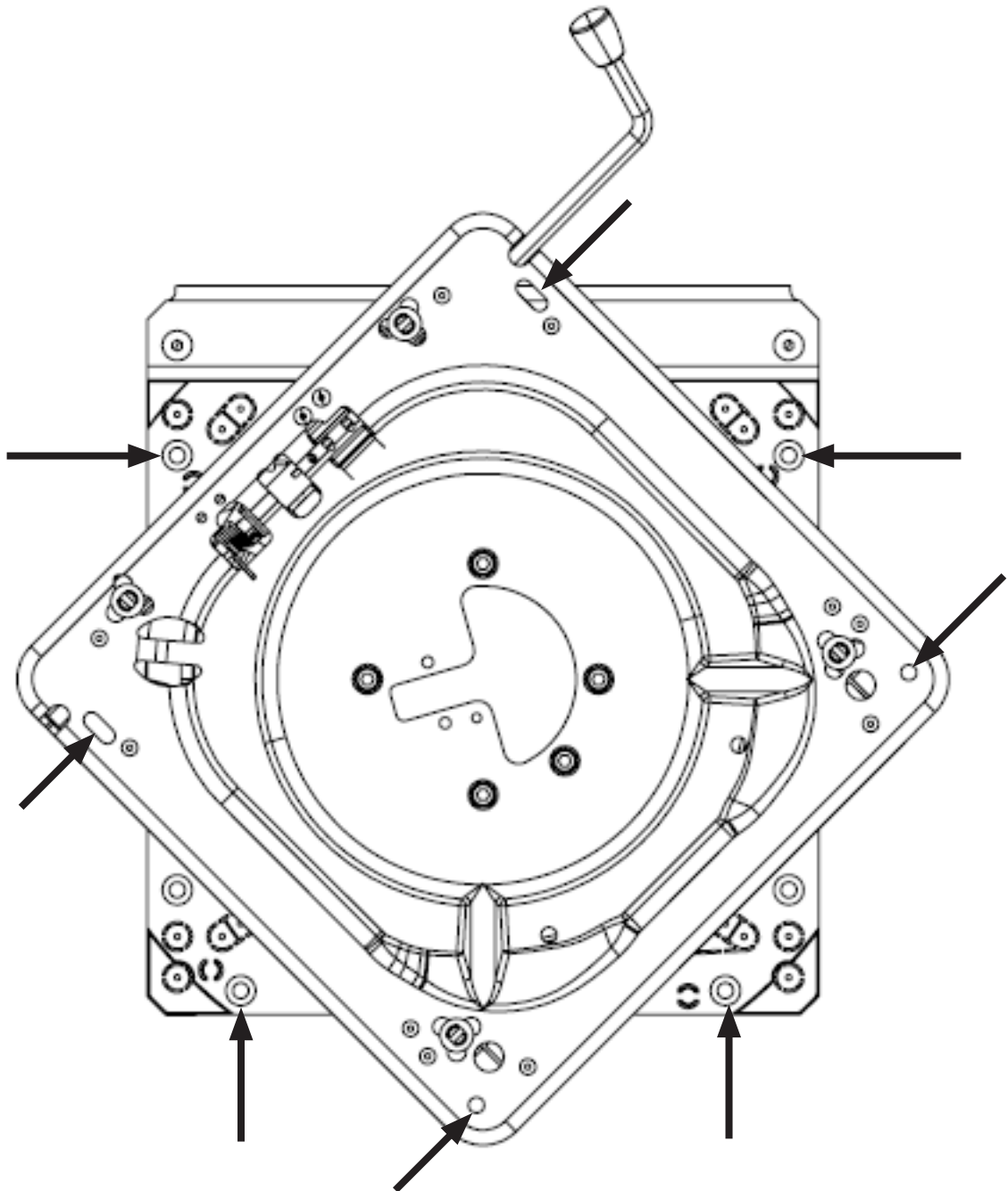

Installation Guide

KM 402 Kit Air/Mech Installation (PN: 6791 & 6792)

17. Rotate the swivel 45 degrees as shown below.
18. Mount the swivel to the 6080 SAP plate using four 5/16" x 5/8" socket head cap screws, lock washers, and 5/16" jam nuts.

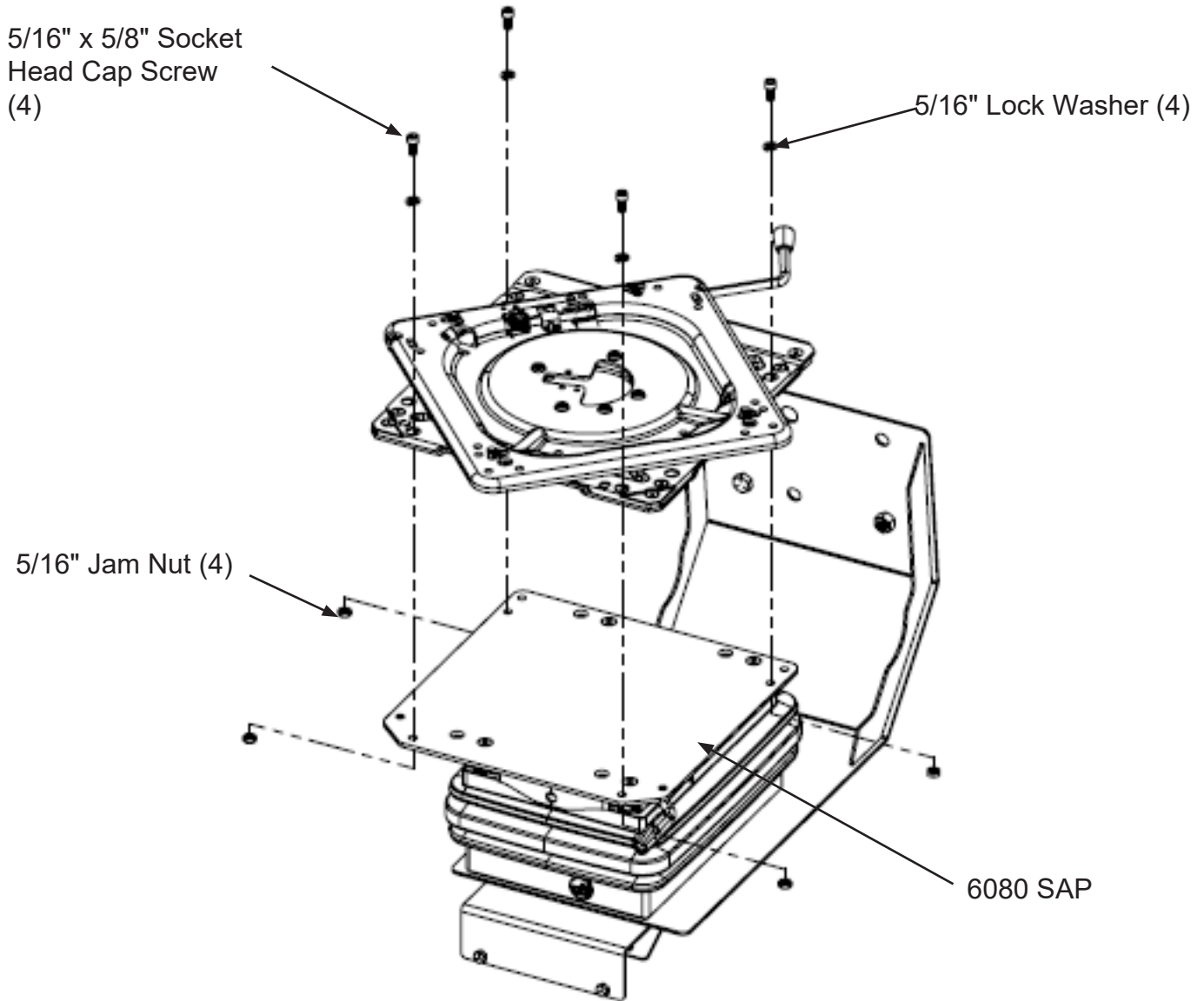

Installation Guide

KM 402 Kit Air/Mech Installation (PN: 6791 & 6792)

19. Remove the cushion from the new seat by taking out the three screws from the bottom front of the seat pan.
20. Mount the seat to the swivel using four 5/16" x 5/8" socket head cap screws and 5/16" serrated flange nuts.
21. Reinstall the seat cushion.
22. If the suspension is air, connect it to a power source. Keyed power is recommended.
23. Installation Complete

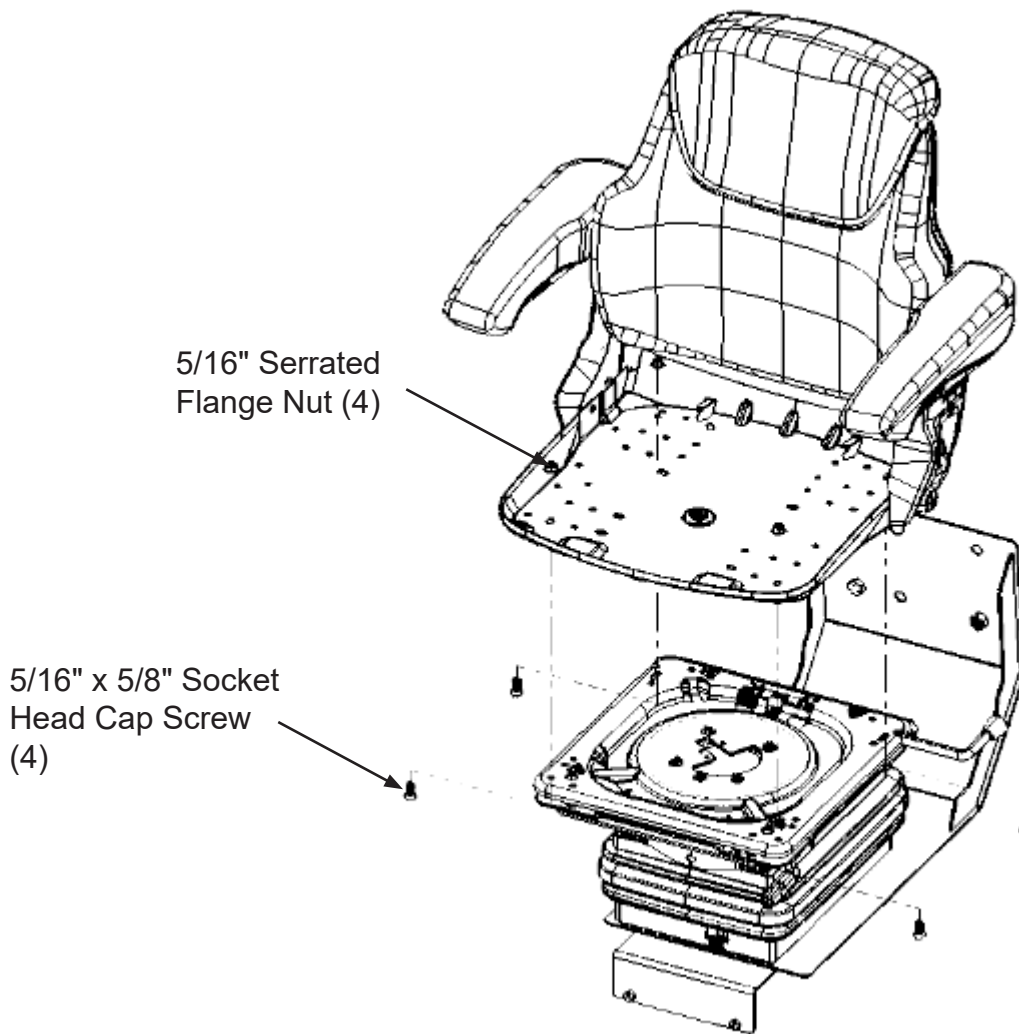

Installation Guide

KM 402 Kit Air/Mech Installation (PN: 6791 & 6792)

24. Continued from step 19. Remove the cushion from the new seat by taking out the three screws from the bottom front of the seat pan.
25. Mount the seat to the 6080 SAP using two 5/16" flat head socket cap screws and serrated flange nuts for the front holes and two 5/16" x 5/8" socket head cap screws and serrated flange nuts for the rear holes.
26. Reinstall the seat cushion.
27. If the suspension is air, connect it to a power source. Keyed power is recommended.

