

JD Drawbar Reinforcements

8000-8020 Series & 8030/R Series

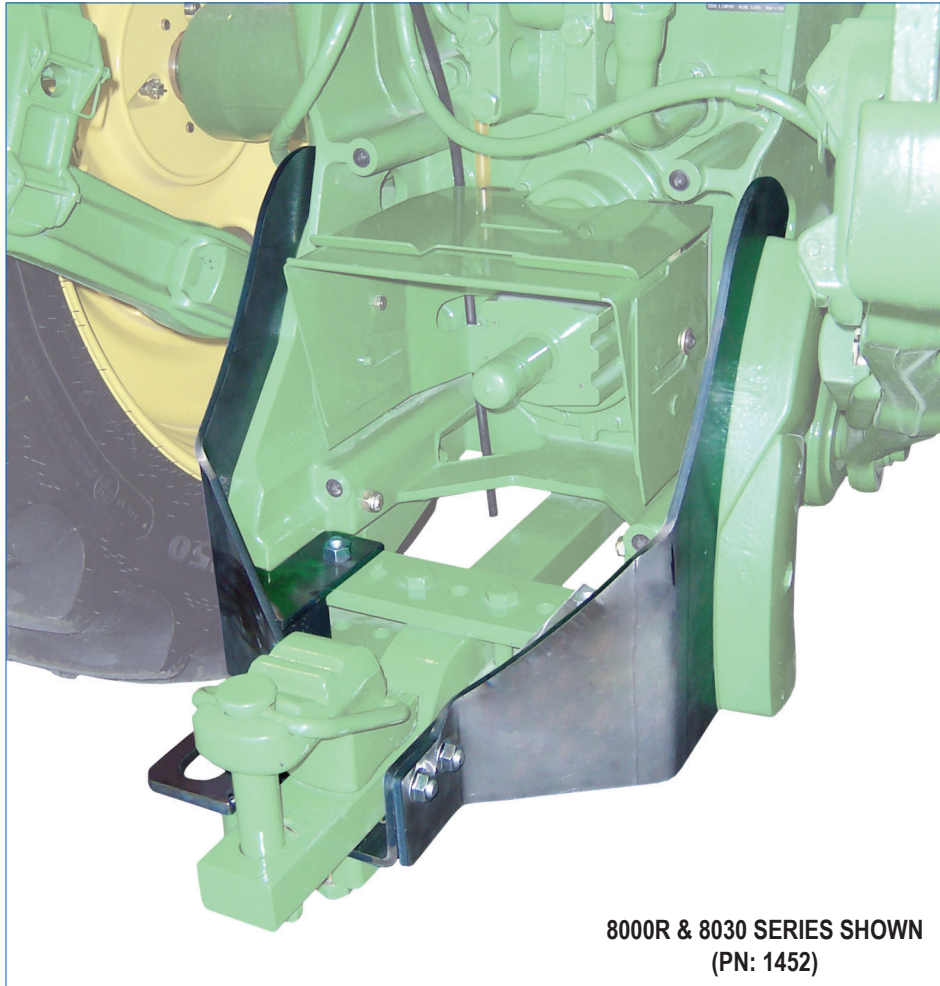

8000R & 8030 SERIES SHOWN
(PN: 1452)

See **REVERSE**
for applications
and part numbers.

- Fits Category 3 (2" x 3") drawbars
- Matches original equipment color
- Adjustable for drawbar settings
- Easy to install
- All hardware included

TRACTORSEATS.com



800-328-1752

308 NW 2nd Street • Renville, MN 56284



APPLICATIONS



Tractors

PN 1451* Fits - John Deere® Tractors

8000 Series: 8100, 8200, 8300, 8400

8010 Series: 8110, 8210, 8310, 8410

8020 Series: 8120, 8220, 8320, 8420

PN 1452** Fits - John Deere® Tractors

8030 Series: 8130, 8230, 8330

R Series: 8225R, 8235R, 8245R, 8270R, 8285R, 2895R

**Note: Will not fit T Series, Track or Row Crop Tractors with heavy-duty drawbars. Will not fit 8520 Series.*

***Note: Does not fit category 4 (2" x 4") heavy-duty drawbars or Tier 4 Final 2015 and new models.*

8000, 8010 & 8020 Installation

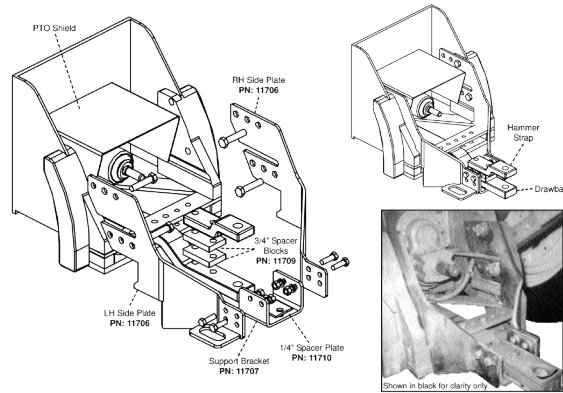

1. Remove the PTO shield as shown above.
2. Install the side plates using the four provided 20mm x 90 mm bolts.
3. Bolt the support bracket to the side plates using four 5/8" x 2" bolts, lock washer and nuts. The 1/4" spacer plate goes between the support bracket and the drawbar.
4. Re-install the PTO shield.

Note: When installing on an Early 8000 Series, use the 3/4" spacer blocks between the drawbar and the hammer strap, as shown. Fasten using the original bolts.

8000R & 8030 Installation

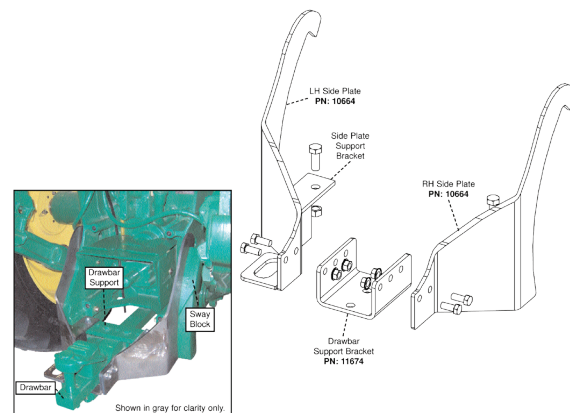

1. Install the side plates by hooking them over the sway blocks.
2. Bolt the drawbar support bracket to the side plates using four 5/8" x 1-1/2" bolts and flange nuts.
3. Bolt the side plate support brackets to the drawbar support using two, 3/4" x 2" bolts and nuts.