

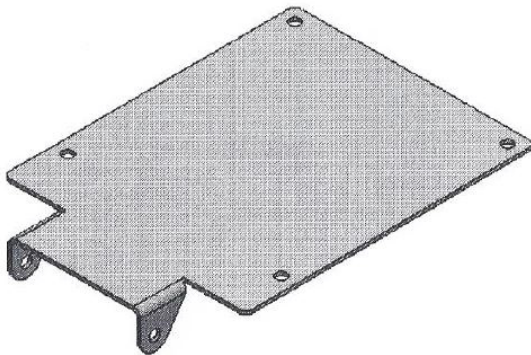

KM 125 PN: 7937



PED PN: 6031

Step 1. Remove old seat by removing clevis pin front of the seat.

Step 2. Attach seat plate PN: 6031 using four 5/16-18 x 1 cap screws flat washers and lock washers.
(See picture below for bolt locations.)

Step 3. Install seat on tractor using the clevis pin removed in step 1.

NOTE: If optional arm rest is used install prior to seat installation.



Attachment points