

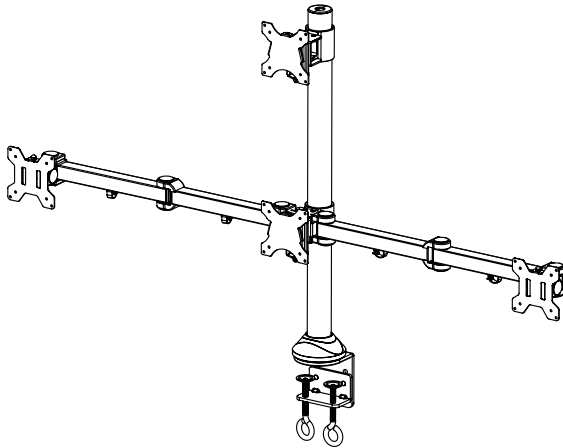

Quad Monitor Desk Mount

Instruction Manual



SKU: STAND-V104A



Scan the QR code with your mobile device or follow the link for helpful videos and specifications related to this product.

<https://vivo-us.com/products/stand-v104a>



help@vivo-us.com



www.vivo-us.com



1-800-371-5654

WARNING!

If you do not understand these directions, or if you have any doubts about the safety of the installation, please call a qualified technician. Check carefully to make sure there are no missing or defective parts. Improper installation may cause damage or serious injury. Do not use this product for any purpose that is not explicitly specified in this manual. Do not exceed weight capacity. We cannot be liable for damage or injury caused by improper mounting, incorrect assembly or inappropriate use.

TIPOVER WARNING

SERIOUS OR FATAL CRUSHING INJURIES CAN OCCUR FROM TIPOVER. TO HELP PREVENT TIPOVER:

- NEVER ALLOW CHILDREN TO CLIMB, STAND, HANG, OR PLAY ON ANY PART OF MONITOR OR STAND.
- USE TIPOVER RESTRAINT OR ANCHOR STAND TO WALL

USE OF TIPOVER RESTRAINTS MAY ONLY REDUCE, BUT NOT ELIMINATE RISK OF TIPOVER.

WARNING: CHOKING HAZARD

SMALL PARTS - NOT FOR CHILDREN UNDER 3 YEARS. ADULT SUPERVISION IS REQUIRED.

PACKAGE CONTENTS

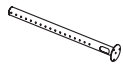

a (x1)
Pole



b1 (x1)
Clamp



b2 (x1)
Clamp Brace



c (x1)
Decorative
Cover

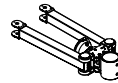

d1 (x1)
Monitor Arm

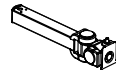

d2 (x2)
Monitor Arm



d3 (x1)
Monitor Mount



e (x4)
Arm Cover



f (x4)
Plastic Pad



g (x2)
M10x47



h (x3)
Clamp Brace
Bolt



i (x2)
M10x15



j (x4)
M8x10



k (x1)
M10 Bolt



l (x1)
Support Plate



m (x1)
M10 Washer



n (x1)
Spring Washer



o (x1)
Foam Pad



p (x16)
M4x12



q (x16)
M4x30



r (x16)
M4 Spacer



s (x2)
Spare Cap



t (x1)
Allen Wrench



u (x1)
Wrench



v1 (x2)
VESA Plate



v2 (x2)
VESA Plate



w1 (x2)
Nut



w2 (x2)
M4x6



x (x4)
Wire Clip

NOTE: NOT ALL HARDWARE INCLUDED WILL BE USED

TOOLS NEEDED

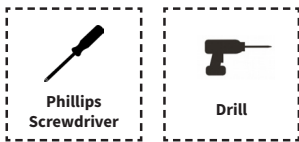

DO NOT EXCEED WEIGHT CAPACITY.

Failure to do so may result in serious injury.

22 lbs
(10 kg)

PER ARM

ASSEMBLY STEPS

STEP 1

OPTION A: Weighted Base Installation

Attach clamp brace (**b2**) to pole (**a**) with clamp brace bolts (**h**). Attach clamp (**b1**) to clamp brace at desired height using M10x15 bolts (**i**) with Allen wrench (**t**). Tighten clamp to desk and slide decorative cover (**c**) into place.

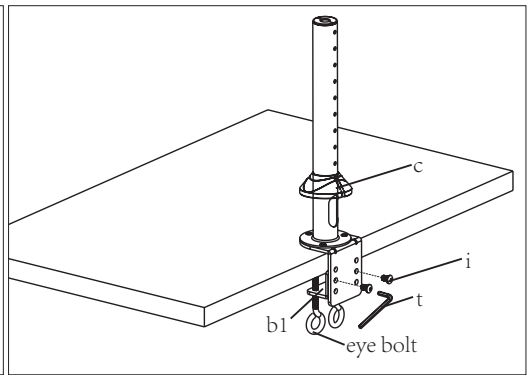
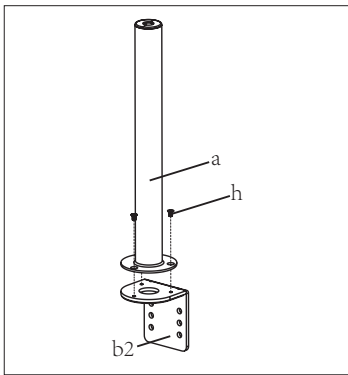

OPTION B: Existing Grommet Base Installation

Apply foam pad (**o**) to base of pole (**a**). Mount pole to grommet hole in desk using M10 bolt (**k**), spring washer (**n**), M10 washer (**m**) and support plate (**l**). Tighten with wrench (**u**) and slide decorative cover (**c**) into place.

Figure 3

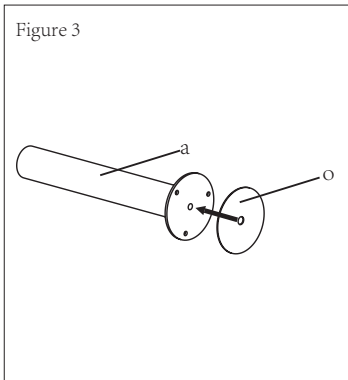
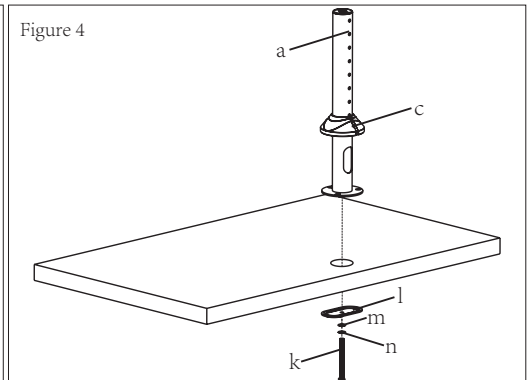

Figure 4



STEP 1 (Continued)

OPTION C: Self-Drilled Grommet Base Installation

Drill a 3/8" (10mm) diameter hole at desired location. Apply foam pad (o) to base of pole (a). Mount pole to grommet hole in desk using M10 bolt (k), spring washer (n), M10 washer (m) and support plate (l). Tighten with wrench (u) and slide decorative cover (c) into place.

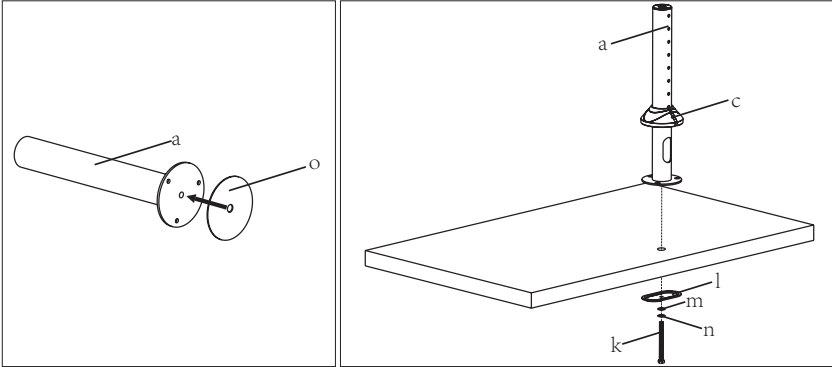

STEP 2

Place plastic pads (f) onto ends of monitor arms (d2), insert into arms (d1), and secure using M10x47 bolts (g) with Allen wrench (t). Press monitor arm covers (e) onto joints.

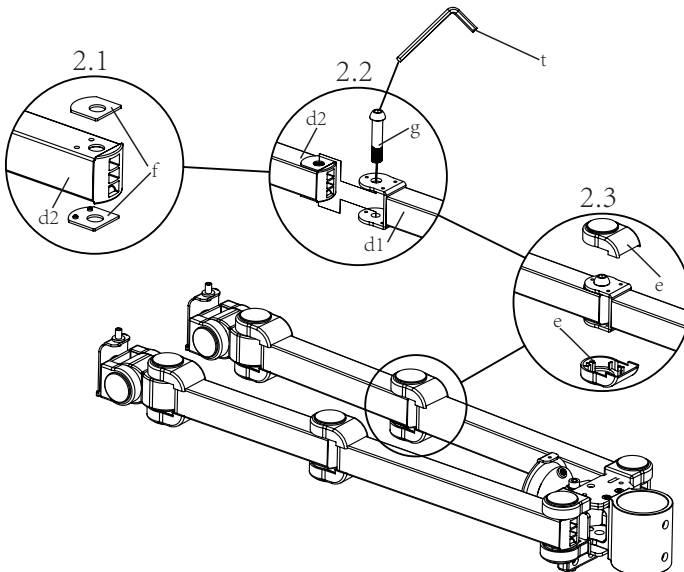

STEP 3

Install wire clips (**x**) on arms (**d1,d2**). Install arms on pole (**a**) at desired height using M8x10 bolts (**j**) with Allen wrench (**t**), making sure wire clips are facing down. Repeat for monitor mount (**d3**).

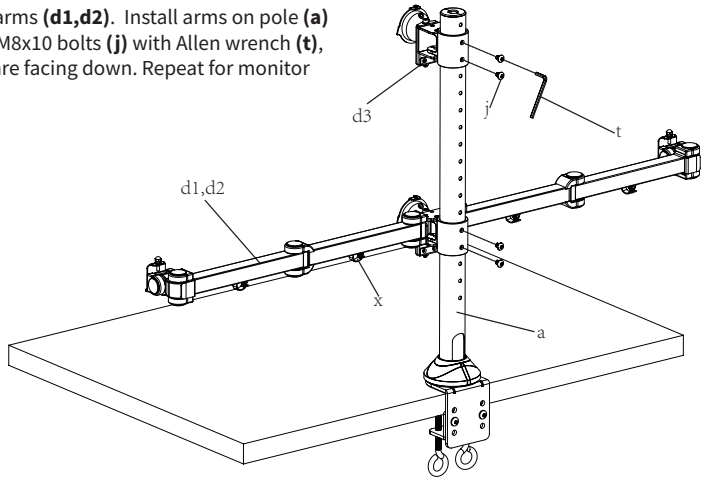

STEP 4

4A: Side VESA Plates

For monitors with flat back attach VESA plates (**v1**) with thumb screws (**p**). For monitors with curved back attach VESA plates (**v1**) with screws (**q**) and spacers (**r**). Screws need only to be finger-tight.

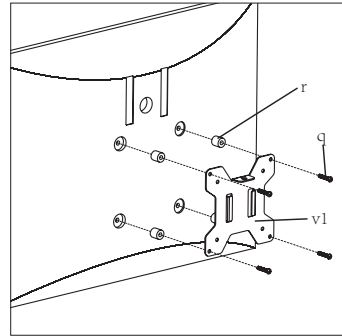
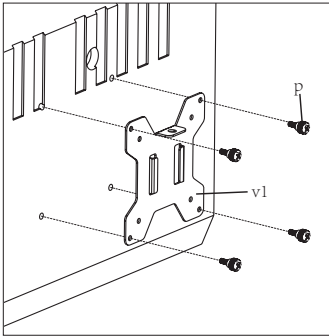

4B: Center VESA Plates

For monitors with flat back attach VESA plates (**v2**) with thumb screws (**p**). For monitors with curved back attach VESA plates (**v2**) with screws (**q**) and spacers (**r**). Screws need only to be finger-tight.

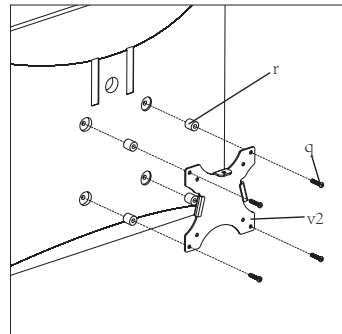
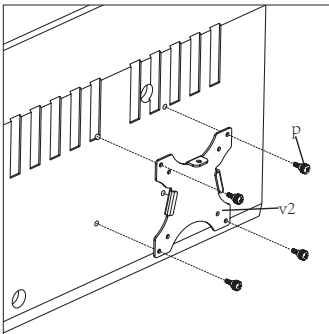

STEP 5

5A: Side VESA Plates

Slide monitor onto the head of arm (**d2**) as shown in the diagram. Secure with nut (**w1**).

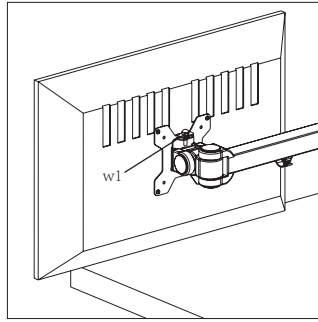
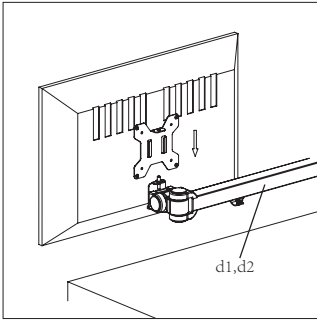

5B: Center VESA Plates

Slide monitor onto the head of arm (**d2**) as shown in the diagram. Secure with screw (**w2**). Slide top monitor onto mount (**d3**) in same fashion. Secure with screw (**w2**).

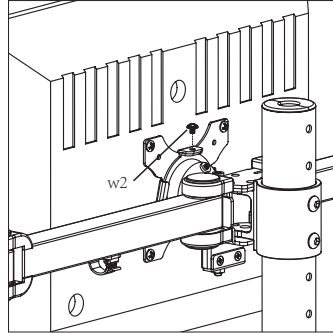
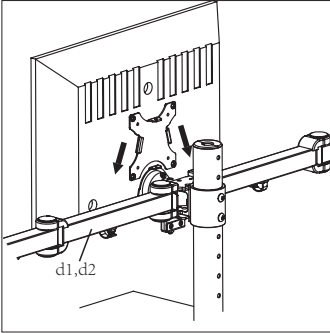

STEP 6

Adjust Tilt Angle of Monitors. Remove plastic cover and use wrench (**u**) to tighten the nut if the tilt angle cannot be fixed. Fasten the grub screws on the center monitors to fix the tilt angle using Allen wrench (**t**).

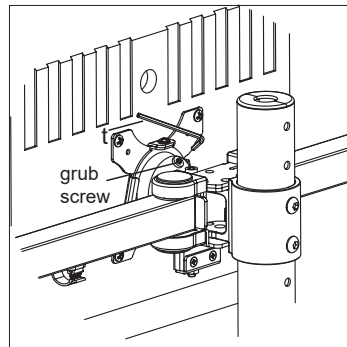
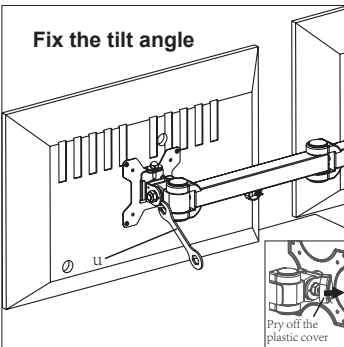

STEP 7

Adjust the height of Center Monitors: Turn the bolt counter-clockwise to lower the center monitors. Turn the bolt clockwise to raise the center monitors. Use allen wrench (**t**). **Adjust the height of the Side Monitors:** Remove nut (**w1**) and turn the bolt counter-clockwise to raise the monitor. Use allen wrench (**t**).

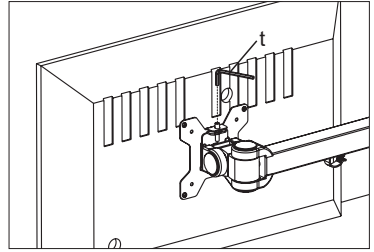
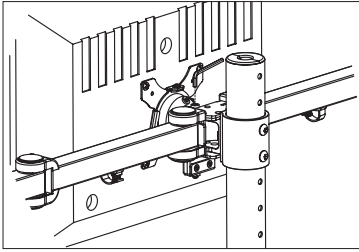

STEP 8

To adjust swivel joint tension, remove the monitor arm cover (**e**) and turn the bolt underneath with the Allen key (**t**).

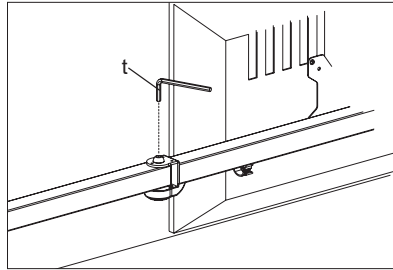

STEP 9

Use wire clips (**x**) to help manage wires.

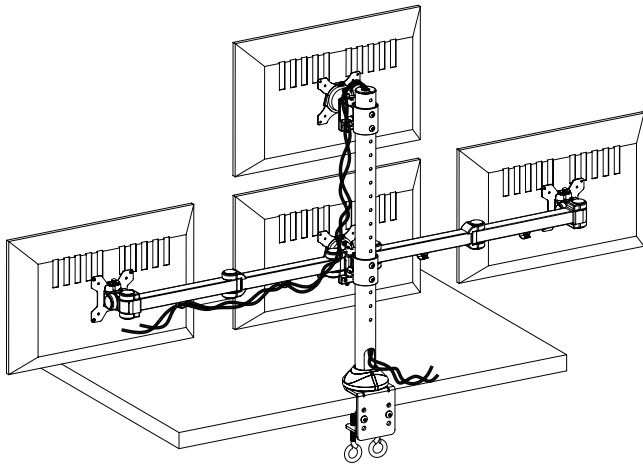



Love your new VIVO setup and want to share?

Tag us in your photo! **@vivo_us**

Last Updated: 08/29/2019



If any parts are received damaged or defective, please contact us. We are happy to replace parts to ensure you have a fully functioning product.



help@vivo-us.com



www.vivo-us.com



1-800-371-5654

For more VIVO products, check out our website at:

www.vivo-us.com.